

Griswold Pump Company

ANSI Pump Interchangeability Guide

Griswold 811 & Goulds 3196, 3796 & 3996

May, 2002

Griswold 811 parts are interchangeable with Goulds 3196 ANSI pumps in equivalent sizes and with Goulds 3796 and 3996 pumps for many of the key parts. Impellers, stuffing box covers, packing glands and shaft sleeves are interchangeable in the model 3996 vertical inline process pumps. All parts, except the casing, are interchangeable in the Goulds 3796 self-priming pump.

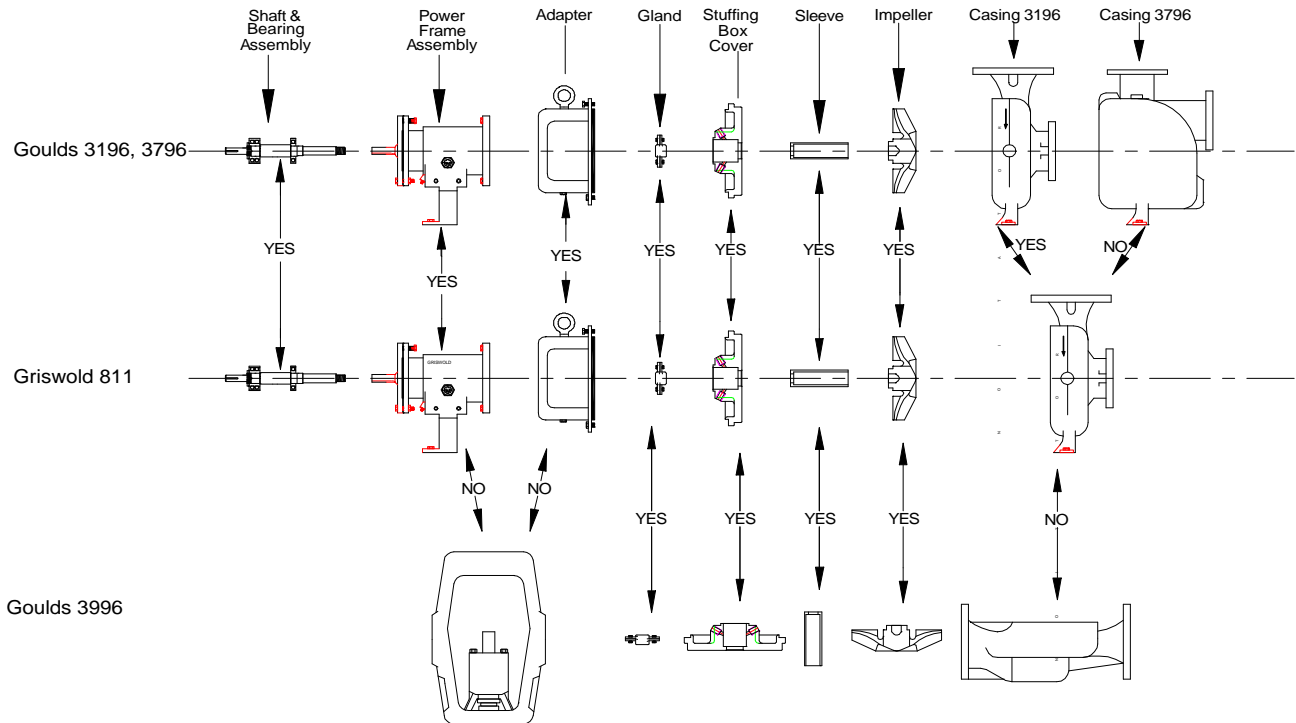

3996 Adapter is integral with
Bearing Housing

**Griswold Pump Company
 Model 811
 ANSI Pump Interchangeability Guide
 May, 2002**

Table Of Contents

<u>Sectional Drawings</u>	<u>Page</u>	<u>Liquid End Parts (Cont.)</u>	<u>Page</u>
Power Frames		3 x 2 x 6	16
Small Power Frame (STX)	3	4 x 3 x 7	17
Medium Power Frame (MTX)	3	3 x 2 x 8	18
Large Power Frame (LTX)	4	4 x 3 x 8	19
Extra Large Power Frame (XLTX)	4	4 x 3 x 8 G	20
		2 x 1 x 10	21
		3 x 1 1/2 x 10	22
Liquid Ends		3 x 2 x 10	23
Small (STX)	5	4 x 3 x 10	24
Medium (MTX)	6	4 x 3 x 10 H	25
Large (LTX)	6	6 x 4 x 10	26
Extra Large (XLTX)	6	6 x 4 x 10 G	27
		6 x 4 x 10 H	28
		3 x 1 1/2 x 13	29
Power Frame Parts		3 x 2 x 13	30
Small Power Frame (STX)	7	4 x 3 x 13	31
Medium Power Frame (MTX)	8	6 x 4 x 13	32
Large Power Frame (LTX)	9	2 x 1 x 10	33
Extra Large Power Frame (XLTX)	10	3 x 1 1/2 x 10	34
		3 x 2 x 10	35
		4 x 3 x 10	36
		4 x 3 x 10 H	37
		6 x 4 x 10	38
		6 x 4 x 10 G	39
		6 x 4 x 10 H	40
		3 x 1 1/2 x 13	41
		3 x 2 x 13	42
		4 x 3 x 13	43
		6 x 4 x 13	44
		6 x 8 x 15	45
		8 x 10 x 15	46
			47 - 55

Griswold Model 811 Small Power Frame (STX)

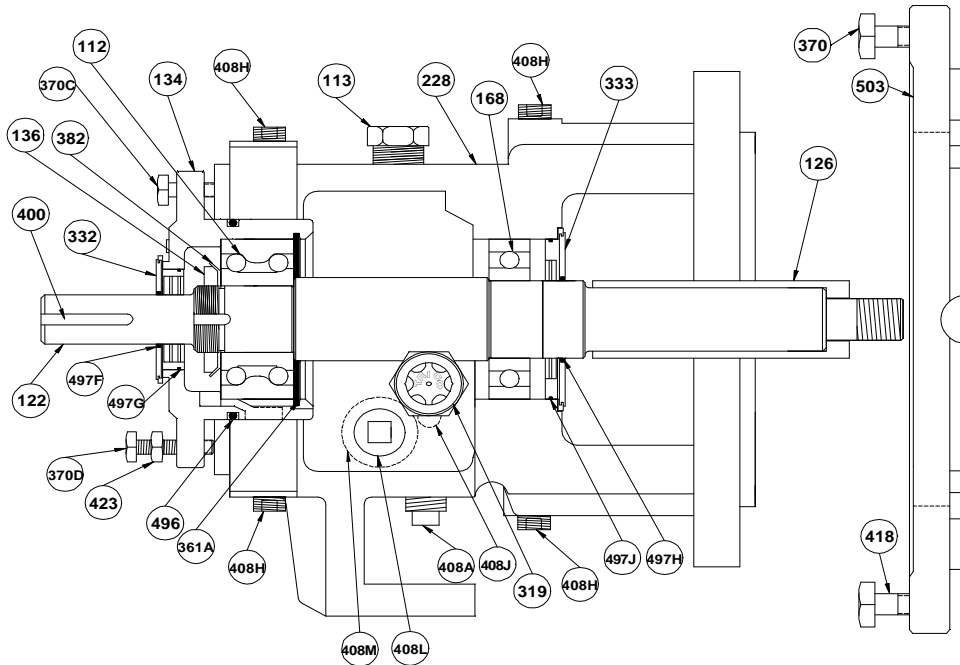

Griswold Model 811 Medium Power Frame (MTX)

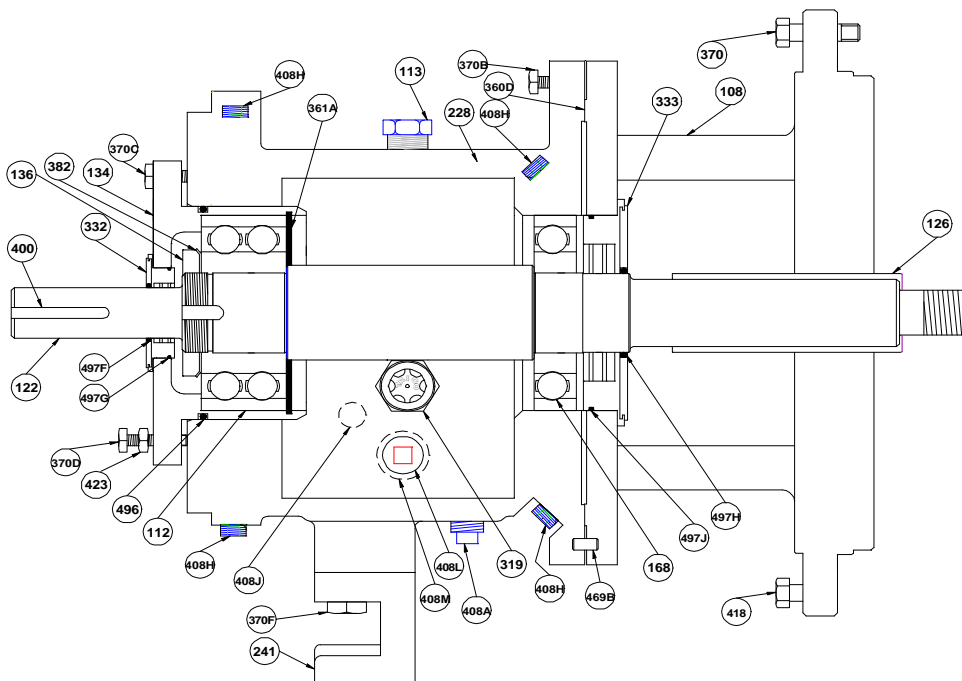

Griswold Pump Company - 107 Plantation Oak Drive - Thomasville, Georgia 31792
Phone (229) 226-5255 - (800) 843-9222 Fax (229) 226-5567 - (800) 752-2929

Griswold Model 811 Large Power Frame (LTX)

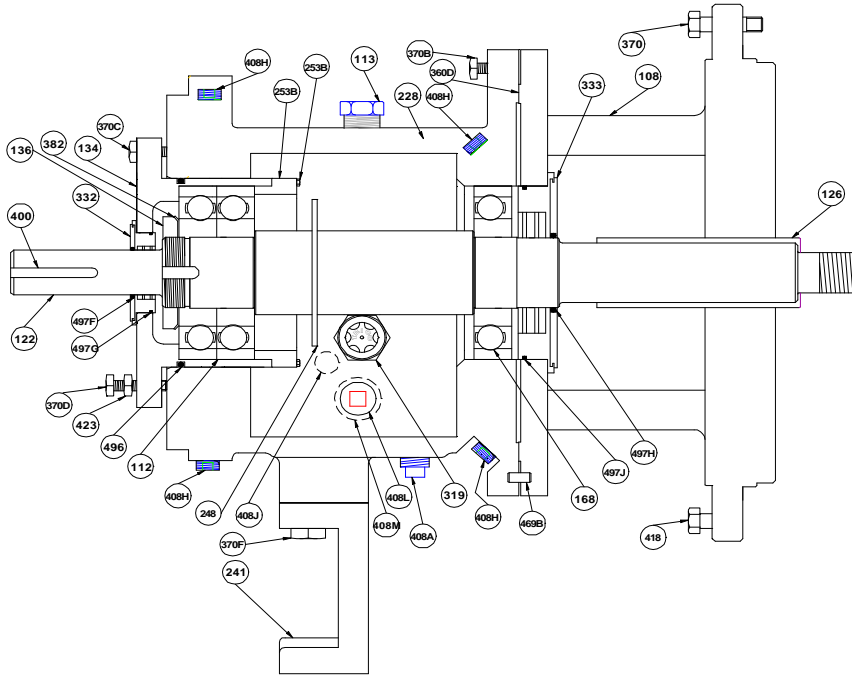

Griswold Model 811 Extra Large Power Frame (XLTX)

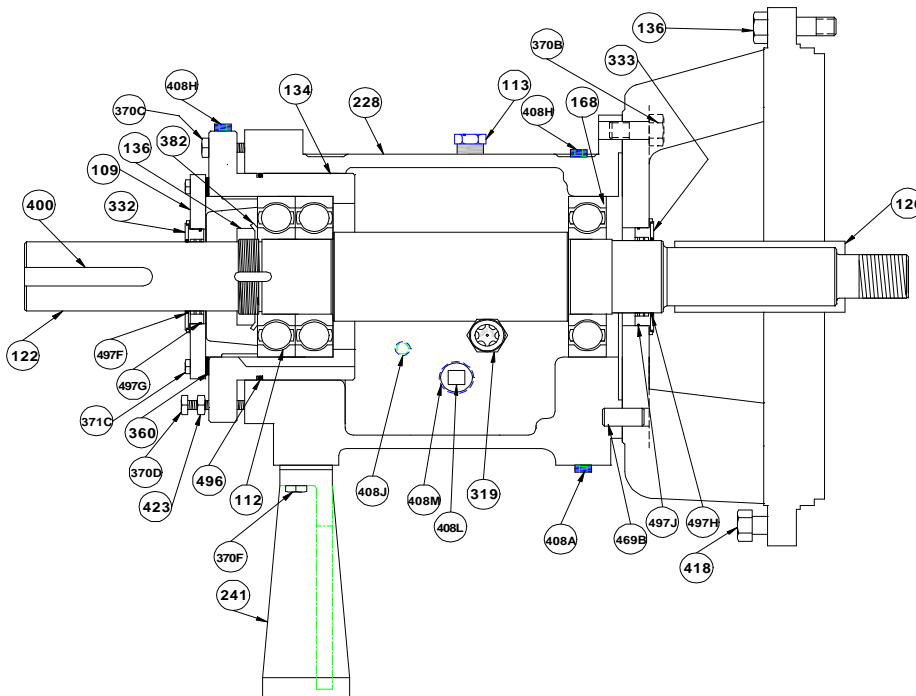

Griswold Pump Company - 107 Plantation Oak Drive - Thomasville, Georgia 31792
Phone (229) 226-5255 - (800) 843-9222 Fax (229) 226-5567 - (800) 752-2929

**Griswold Model 811
Sectional Drawing
Liquid End For Small Frame Pump (STX)**

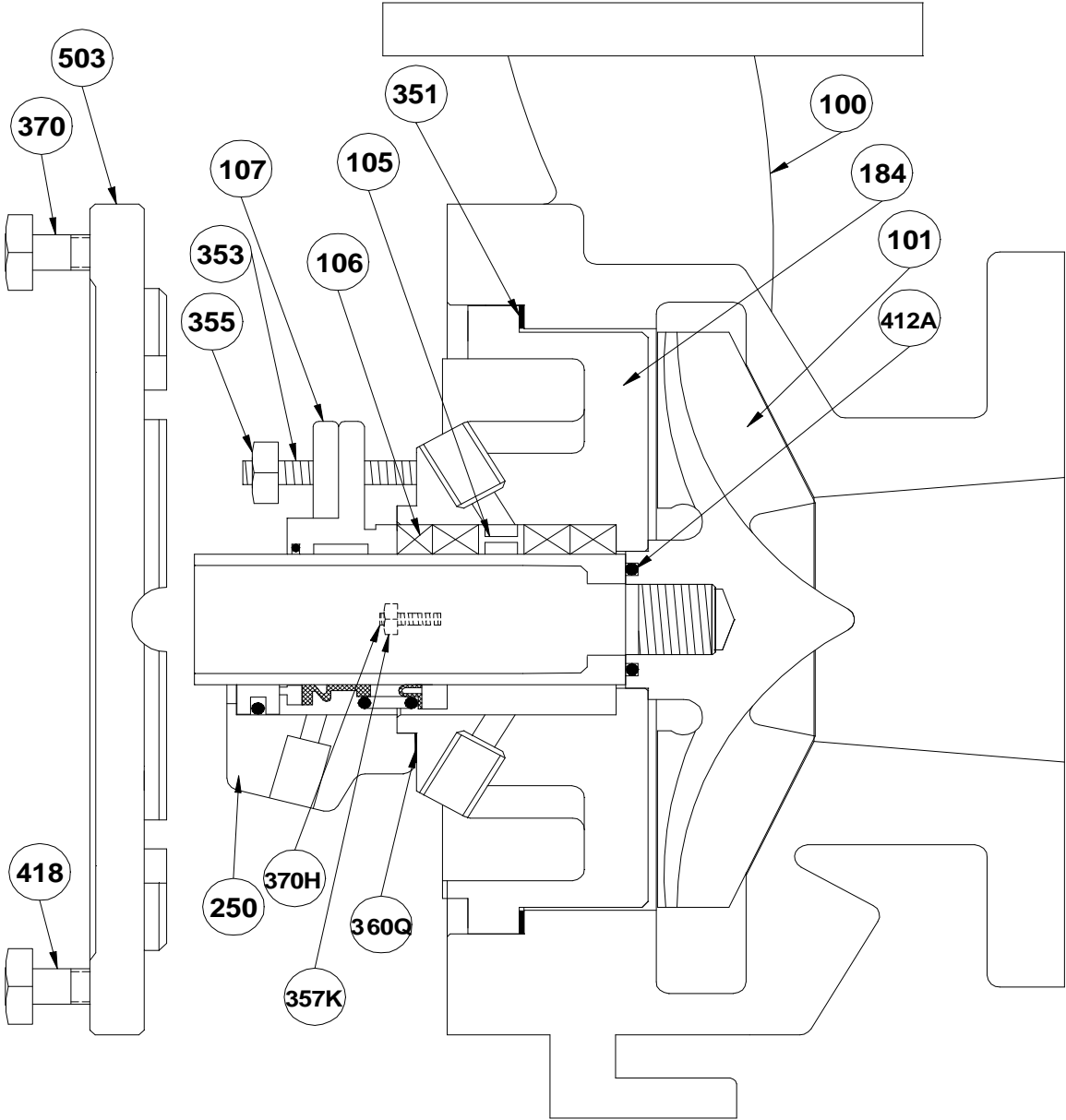

**Griswold Pump Company - 107 Plantation Oak Drive - Thomasville, Georgia 31792
Phone (229) 226-5255 - (800) 843-9222 Fax (229) 226-5567 - (800) 752-2929
Prices subject to change without notice.**

**Griswold Model 811
Sectional Drawing
Liquid End For Medium, Large & Extra Large Frame Pumps
MTX , LTX & XLTX**

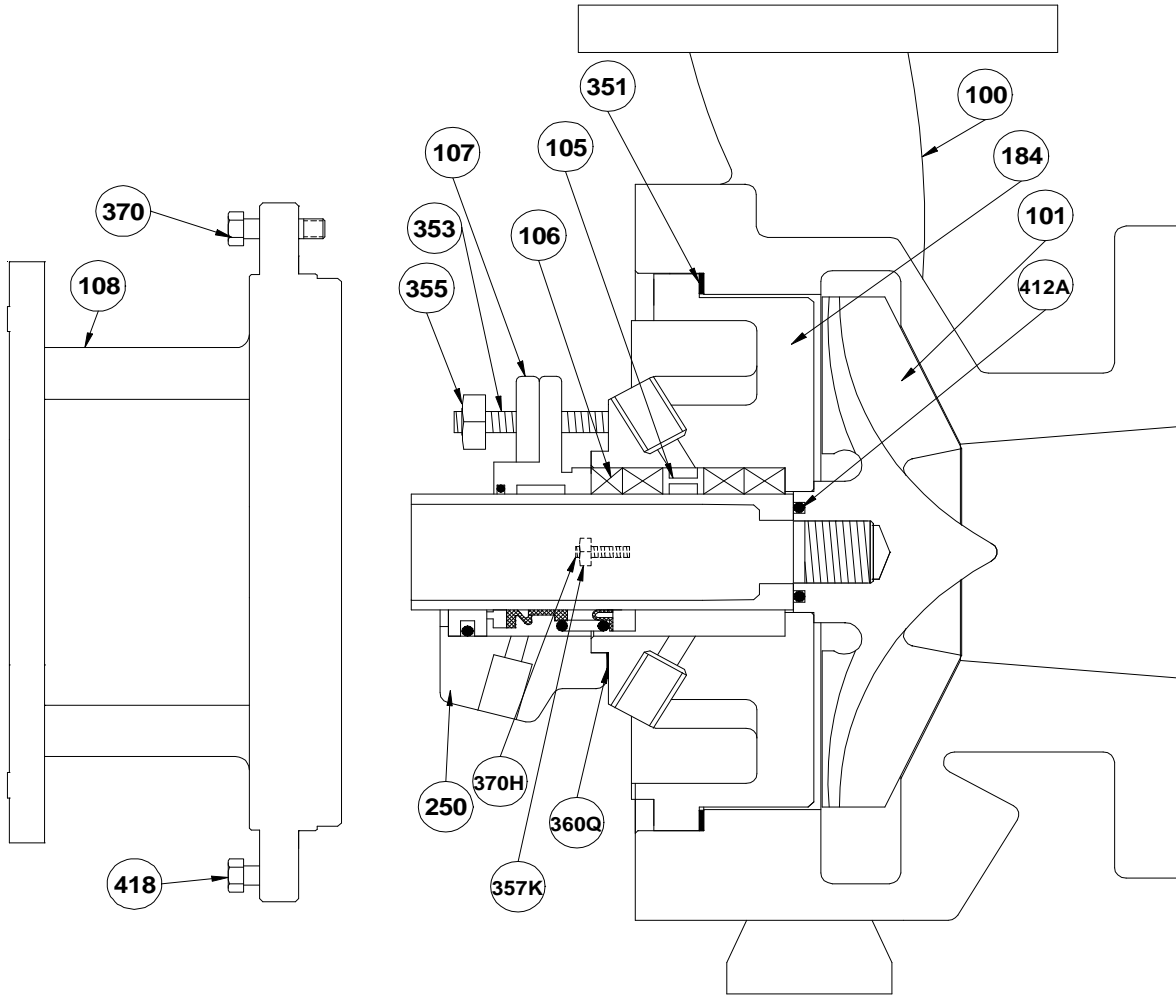

**Griswold Pump Company - 107 Plantation Oak Drive - Thomasville, Georgia 31792
Phone (229) 226-5255 - (800) 843-9222 Fax (229) 226-5567 - (800) 752-2929
Prices subject to change without notice.**

Small Power Frame Parts
Model 811 - Small Frame - (Replaces 3196 STX)

Part	Item #	Qty Req.	Material	Griswold Part #	Goulds Part #
Outboard Bearing	112	1	Steel	18463-10	8049-30600
Oil Fill Plug	113	1	Steel	8505-03-01	6312242210
Shaft for sleeve design	122	1	4140	24000-01-41A	R104-435-2238
Shaft for sleeve design			316 SS	24000-01-31A	R104-435-2229
Shaft for sleeveless design			316 SS	24000-02-31A	R104-434-2229
Shaft for sleeveless design			A20	24000-02-20A	R104-434-2230
Deflector ST Only	123	1	Fld-Tef	18422-06-94	76776-1
Sleeve	126	1	316 SS	21339-01-91	76772X-2229
			Alloy 20	21399-01-20	76772X-2230
Bearing Housing	134	1	Cast Iron	24082-01-01	C03340A100056097
Thrust Bearing Locknut	136	1	Steel	6123-1	8601-0006
Inboard Bearing	168	1	Steel	18463-11	8050-20760
Frame	228	1	Duct Iron	24340-01-01	RD04539AA101363977
Sight Glass	319	1	Stl/Glass	34307	A01154A05
Outboard Lab'y Seal	332	1	Teflon	18470-1P	D08717A016241
Outboard Lab'y Seal INPRO		1	Bronze	18470-1	A00915A01
OutBoard Bearing Lip Seal		1	Buna	18465-9	860-13535
Inboard Lab'y Seal	333	1	Teflon	18470-2P	D08717A026241
Inboard Lab'y Seal INPRO		1	Bronze	18470-2	A00930A01
Inboard Bearing Lip Seal		1	Buna	18465-10	8690-63447
Thrust Bearing Lockwasher	382	1	Steel	6124-1	8910-0006
Coupling Key	400	1	Steel	4372-23-21	49568612213
Bearing Housing Hex Jam Nut	423	3	Steel	3932-8	49507542210
Bearing Housing O-Ring	496	1	Buna	18461-04-71	C02495A236-5302
Bearing Housing Retaining Ring	361A	1	Steel	18464-1	58101281
Bolts Bearing Housing - Frame	370C	3	Steel	14129613	495211042210
Bolts Bearing Housing Impeller Adju	370D	3	Steel	14129613	495211042210
Oil Drain Plug	408A	1	Steel	6652-1	A00152A01
Oil Mist Connection Plug	408H	4	Steel	8505-02-02	57042-103
Constant Oiler Plug	408J	1	Steel	8505-02-03	63122-2-2210
Finned Tube Cooler Inlet Plug 1/2" NF	408L	1	Steel	23445-2	7301-0008
Finned Tube Cooler Outlet Plug 1" NF	408M	1	Steel	31006307	7301-0016
O-Ring Outboard Lab'y Seal - Rotatin	497F	1	Viton	20V	C02495A20-5304
O-Ring Outboard Lab'y Seal - Station	497G	1	Viton	24V	C02495A24-5304
O-Ring Inboard Lab'y Seal - Rotating	497H	1	Viton	220V	C02495A220-5304
O-Ring Inboard Lab'y Seal - Stationar	497J	1	Viton	146V	C02495A146-5304
8" Adapter Ring	503		Duct Iron	24215-01-01	76782-1013
Power Frame For Sleeveless Design	920A	1	316 SS Sha	PF811SM91NSLV	P1600S0S00-X080
			A20 Shaft	PF811SM20NSLV	P1600S0S00-X000
Power Frame For Sleeve Design	920B	1	4140 Shaft	PF811SM41SLV	P1600S0S00-X050
			316 SS Sha	PF811SM91SLV	P1600S0S00-X060

Griswold Pump Company - 107 Plantation Oak Drive - Thomasville, Georgia 31792
Phone (229) 226-5255 - (800) 843-9222 Fax (229) 226-5567 - (800) 752-2929

Medium Power Frame Parts
Model 811 - Medium Frame - (Replaces 3196 MTX)

Part	Item #	Qty Req.	Material	Griswold Part #	Goulds Part #
Outboard Bearing	112	1	Steel	18463-12	8049-30900
Oil Fill Plug	113	1	Steel	8505-03-01	63122-4-2210
Shaft for sleeve design	122	1	4140	24001-01-41A	R104-733-2238
Shaft for sleeve design			316 SS	24001-01-31A	R104-733-2229
Shaft for sleeveless design			316 SS	24001-02-31A	R104-731-2229
Shaft for sleeveless design			A20	24001-02-20A	R104-731-2230
Deflector MT Only	123	1	Fld-Tef	18422-07-94	73519-2
Sleeve	126	1	316SS	21276-01-91	73705X-2229
			Alloy 20	21276-01-20	73705X2230
Bearing Housing	134	1	Cast Iron	24383-01-01	D04872A100056376
Thrust Bearing Locknut	136	1	Steel	6123-6	8601-0009
Inboard Bearing	168	1	Steel	18463-13	8050-30960
Frame	228	1	Cast Iron	24288-01-01	RD04540AA100163983
Frame Foot 8" & 10"	241	1	Cast Iron	24421-01-01	B02092A-1001-63987
Frame Foot 13"				24420-01-01	B02091A-1001-63986
Sight Glass	319	1	St&Glass	34307	A01154A05
Outboard Lab'y Seal	332	1	Teflon	18470-4P	D08717A03-6241
Outboard Lab'y Seal INPRO		1	Bronze	18470-4	A00746A01
OutBoard Bearing Lip Seal		1	Buna	18465-11	8690-11220
Inboard Lab'y Seal	333	1	Teflon	18470-5P	D08717A04-6241
Inboard Lab'y Seal INPRO		1	Bronze	18470-5	A00745A01
Inboard Bearing Lip Seal		1	Buna	18465-12	8690-17645
Thrust Bearing Lockwasher	382	1	Steel	6124-6	8910-0009
Coupling Key	400	1	Steel	4372-02-21	49568-118-2213
Bearing Housing Hex Jam Nut	423	3	Steel	3932-62	49507-57-2210
Bearing Housing O-Ring	496	1	Buna	18461-01-71	CO2495A245-5304
Bearing Housing Retaining Ring	361A	1	Steel	18464-14	5810139313
Capscrew Frame - Adapter	370B	4	Steel	3861-22	49511-204-2210
Bolts Bearing Housing - Frame (Sar	370C	3	Steel	3831-92	49521-204-2210
Bolts Bearing Housing Impeller Adju	370D	3	Steel	3831-92	49521-204-2210
Capscrews Frame - Foot	370F	2	Steel	14178701	49511-203-2210
Oil Drain Plug	408A	1	Steel	6652-1	A00152A01
Oil Mist Connection Plug	408H	4	Steel	8505-02-02	57042-103
Constant Oiler Plug	408J	1	Steel	8505-02-03	63122-2-2210
Finned Tube Cooler Inlet Plug 1/2" N	408L	1	Steel	8505-04-01	7301-0008
Finned Tube Cooler Outlet Plug 1" N	408M	1	Steel	31006307	7301-0016
Dowel Pin Frame - Adapter	469B	2	Steel	8372	73523-3
O-Ring Outboard Lab'y Seal - Rotatir	497F	1	Viton	216V	C024951A2165304
O-Ring Outboard Lab'y Seal - Station	497G	1	Viton	224V	C02495A2245304
O-Ring Inboard Lab'y Seal - Rotating	497H	1	Viton	224V	C02495A2245304
O-Ring Inboard Lab'y Seal - Stationa	497J	1	Viton	231V	C02495A2315304
Power Frame For Sleeveless Design	920A	1	316 SS Shaf	PF811MD91NSLV	P1600M0S00-X080
			A20 Shaft	PF811MD20NSLV	P1600M0S00-X000
Power Frame For Sleeve Design	920B	1	4140 Shaft	PF811MD41SLV	P1600M0S00-X050
			316 SS Shaf	PF811MD91SLV	P1600M0S00-X060

Large Power Frame Parts
Model 811 - Large Frame - (Replaces 3196 LTX)

Part	Item #	Qty Req.	Material	Griswold Part #	Goulds Part #
Outboard Bearing	112	2	Steel	18463-16	R8057-3-1029
Oil Fill Plug	113	1	Steel	8505-03-01	63122-4-2210
Shaft for sleeve design	122	1	4140	24002-01-41A	RC03044A-2238
Shaft for sleeve design			316 SS	24002-01-31A	RC03044A-2229
Shaft for sleeveless design			316 SS	24002-02-31A	RC03132A-2229
Shaft for sleeveless design			A20	24002-02-20A	RC03132A-2230
Deflector LTC	123	1	Fld-Tef	18422-08-94	73519-3
Sleeve	126	1	316SS	21551-01-91	91967X-2229
			Alloy 20	21551-01-20	91967X-2230
Bearing Housing	134	1	Cast Iron	24384-01-01	D04628A-1000-68227
Thrust Bearing Locknut	136	1	Steel	6123-5	8601-0010
Inboard Bearing	168	1	Steel	18463-15	8050-31160
Frame	228	1	Cast Iron	24288-02-01	RD04548AA-1001-63984
Capscrews, Clamp Ring	236A	10	Steel	24384-03-01	49511-50-2210
Frame Foot 8" & 10"	241	1	Cast Iron	24421-01-01	B02092A-1001-63987
Frame Foot 13"				24420-01-01	B02091A-1001-63986
Oil Thrower	248	1	Steel	24384-04-41	A03712A-3201
Clamp Ring	253B	1	Steel	24384-02-41	B02168A-2210
Sight Glass	319	1	St&Glass	34307	A01154A05
Outboard Lab'y Seal	332	1	Tefln	18470-7P	D08717A05-6241
Outboard Lab'y Seal INPRO		1	Bronze	18470-7	A00710A01
OutBoard Bearing Lip Seal		1	Buna	18465-13	8690-18727
Inboard Lab'y Seal	333	1	Tefln	18470-8P	D08717A06-6241
Inboard Lab'y Seal INPRO		1	Bronze	18470-8	A00711A01
Inboard Bearing Lip Seal		1	Buna	18465-14	8690-21228
Thrust Bearing Lockwasher	382	1	Steel	6124-5	8910-0010
Coupling Key	400	1	Steel	4372-08-21	49568-302-2213
Bearing Housing Hex Jam Nut	423	3	Steel	3932-62	49507-57-2210
Bearing Housing O-Ring	496	1	Buna	251B	C02495A251-5302
Capscrew Frame - Adapter	370B	4	Steel	3861-22	49511204-2210
Bolts Bearing Housing - Frame (Sar	370C	3	Steel	3831-92	49521204-2210
Bolts Bearing Housing Impeller Adju	370D	3	Steel	3831-92	49521204-2210
Capscrews Frame - Foot	370F	2	Steel	14178701	49511203-2210
Oil Drain Plug	408A	1	Steel	6652-1	A00152A01
Oil Mist Connection Plug	408H	4	Steel	8505-02-02	57042-103
Constant Oiler Plug	408J	1	Steel	8505-02-03	63122-2-2210
Finned Tube Cooler Inlet Plug 1/2" N	408L	1	Steel	8505-04-01	7301-0008
Finned Tube Cooler Outlet Plug 1" N	408M	1	Steel	31006307	7301-0016
Dowel Pin, Frame to Adapter	469B	2	Steel	8372	73523-3
O-Ring Outboard Lab'y Seal - Rotatir	497F	1	Viton	225V	C024951A225-5304
O-Ring Outboard Lab'y Seal - Station	497G	1	Viton	230V	C02495A230-5304
O-Ring Inboard Lab'y Seal - Rotating	497H	1	Viton	138V	C02495A138-5304
O-Ring Inboard Lab'y Seal - Stationa	497J	1	Viton	147V	C02495A147-5304
Power Frame For Sleeveless Design	920A	1	316 SS Shaft	PF811LG91NSLV	P1600L0S00-X080
			A20 Shaft	PF811LG20NSLV	P1600L0S00-X000
Power Frame For Sleeve Design	920B	1	4140 Shaft	PF811LG41SLV	P1600L0S00-X050
			316 SS Shaft	PF811LG91SLV	P1600L0S00-X060

**Extra Large Power Frame Parts
Model 811 - Extra Large Frame - (Replaces 3196 XLTX)**

Part	Item #	Qty Req.	Material	Griswold Part #	Goulds Part #
Thrust Bearing End Cover	109	1	Cast Iron	24016-01-01	102-828-1001-55356
Outboard Bearing	112	1	Steel	18463-18	8049-31300
Oil Fill Plug	113	1	Steel	3/1/05	63122-4-2210
Shaft for sleeve design	122	1	4140	24003-01-41A	R103-614-2238
Shaft for sleeve design			316 SS	24003-01-31A	R103-614-2229
Shaft for sleeveless design			316 SS	24003-02-31A	R103-615-2229
Shaft for sleeveless design			A20	24003-02-20A	R103-615-2230
Deflector XLT	123	1	Fld-Tef	18422-09-94	73519-8
Sleeve	126	1	316SS	24007-01-31	76230X-2229
			Alloy 20	24007-01-20	76230X-2230
Bearing Housing	134	1	Cast Iron	24015-01-01	D04871A-1001-55357
Thrust Bearing Locknut	136	1	Steel	6125-8	8601-0013
Inboard Bearing	168	1	Steel	18463-17	8050-31360
Frame	228	1	Cast Iron	24011-01-01	RE00666AA-1001-68146
Frame Foot	241	1	Cast Iron	24018-01-01	C04366A-69160
Sight Glass	319	1	ST&Glass	34307	A01154A05
Outboard Lab'y Seal	332	1	Teflon	18470-10P	D08717A07-6241
Outboard Lab'y Seal INPRO		1	Bronze	18470-10	A00786A01
OutBoard Bearing Lip Seal		1	Buna	18465-15	8690-23732
Inboard Lab'y Seal	333	1	Teflon	18470-11P	D08717A08-6241
Inboard Lab'y Seal INPRO		1	Bronze	18470-11	A00785A01
Inboard Bearing Lip Seal		1	Buna	18465-16	8690-25032
Gasket, Brg End Cover to Brg Housin	360	1	VELLUMOID	18408-7	75704-5130-0007
Thrust Bearing Lockwasher	382	1	Steel	6124-8	8910-0013
Coupling Key	400	1	Steel	4372-25-21	49568-409-2213
Hex Tap Bolts- Jacking	418	3	304 SS	3861-22	49521-204-2228
Bearing Housing Hex Jam Nut	423	3	Steel	3932-62	49507-59-2210
Bearing Housing O-Ring	496	1	Buna	252B	C02495A261-5302
Capscrew Frame - Adapter	370B	4	Steel	3861-22	49511-204-2210
Bolts Bearing Housing - Frame	370C	4	Steel	3861-72	49511-254-2210
Bolts Bearing Housing Impeller Adju	370D	4	Steel	3861-82	49521-305-2210
Capscrews Frame - Foot	370F	2	Steel	14178701	49511-203-2210
Capscrew, Brg End Cover to Brg Hou	371C	6	Steel	3861-12	49511-102-2210
Oil Drain Plug	408A	1	Steel	6652-1	A00152A01
Oil Mist Connection Plug	408H	4	Steel	8505-02-02	57042-103
Constant Oiler Plug	408J	1	Steel	8505-02-03	63122-2-2210
Finned Tube Cooler Inlet Plug 1/2" NF	408L	1	Steel	8505-04-01	7301-0008
Finned Tube Cooler Outlet Plug 1" NF	408M	1	Steel	31006307	7301-0016
Dowel Pin, Frame to Adapter	469B	2	Steel	18407-7	71091-3
O-Ring Outboard Lab'y Seal - Rotatin	497F	1	Viton	229V	C02495A229-5304
O-Ring Outboard Lab'y Seal - Station	497G	1	Viton	234V	C02495A234-5304
O-Ring Inboard Lab'y Seal - Rotating	497H	1	Viton	144V	C02495A144-5304
O-Ring Inboard Lab'y Seal - Stationar	497J	1	Viton	151V	C02495A151-5304
Power Frame For Sleeveless Design	920A	1	316 SS Shaft	PF811XLG91NSLV	P1600X0S00-X080
			A20 Shaft	PF811XLGNSLV	P1600X0S00-X000
Power Frame For Sleeve Design	920B	1	4140 Shaft	PF811XLG41SLV	P1600X0S00-X050
			316 SS Shaft	PF811XLG91SLV	P1600X0S00-X060

Phone (229) 226-5255 - (800) 843-9222 Fax (229) 226-5567 - (800) 752-2929

**1 X 1 1/2 X 6 Liquid End Parts
 Model 811 - Small Frame - (Replaces 3196 ST / STX)**

Part	Item #	Qty Req.	Material	Griswold Part #	Goulds Part #
Case	100	1	DI	21424-01-N6	104-421-1012
			316SS	21424-01-91	104-554-1203
			CD4MCu	21424-01-X4	104-554-1216
			Alloy 20	21424-01-20	104-554-1204
Impeller	101	1	DI	21292-20-N6	076777-1013
			316SS	21292-20-91	076781-1203
			CD4MCu	21292-20-X4	076781-1216
			Alloy 20	21292-20-20	076781-1204
Lantern Ring	105	1	Teflon	21414	R76775
Packing	106	1	Tef/Imp	21647-13-7	A01081A14
Plain Gland	107	1	316SS	21415-01-91	RB01049A1203
Stuffing Box - Standard Bore	184	1	DI	21284-01-N6	R104-429-1012
			316SS	21284-01-91	R104-562-1203
			CD4MCu	21284-01-X4	R104-562-1216
			Alloy 20	21284-01-20	R104-562-1204
Stuffing Box - Taper Bore	184	1	DI	24284-02-N6	RC01382A03-1012
			316SS	24284-02-91	RC01382A01-1203
			CD4MCu	24284-02-X4	RC01382A01-1216
			Alloy 20	24284-02-20	RC01382A01-1204
Flush Gland	250	1	Various	Various	Various
Case Gasket (15% Glass-Filled TFE) (FDA Approved)	351	1	EPDM	10399-53-03	70782-81-5127
			Teflon	10399-53-05	70782-81-5117
			Gylon	10399-53-06	70782-81-5118
Gland Stud	353	4	316 SS	21855-01-04	27177-588-2229
Gland Stud Nut	355	4	304 SS	3932-8	495074-2228
Capscrew Frame - Case	370	4	Steel	3861-167	49511-252-2210
Hex Bolts - Jacking	418	2	304 SS	14129613	49521-104-2228
Hex Nut - Stuffing Box Stud	357K	2	304SS	3932-82	495073-2228
Gland Gasket-STD Box	360Q	1	EPDM	18408-4	70782-25-5127
Stud - Stuffing Box	370H	2	304 SS	3862-83	27177-664-2228
Impeller O-Ring	412A	1	Teflon	18461-14-38	C02495A236359
Maintenance Kit	902	1	Various	K-3196S-6	R196-MKS6
Repair Kit	906A	1	Various	RK-3196S	R196STPRKO

Items in bold may or may not be in stock. Longer lead times may be required. RTF.

**3 X 1 1/2 X 6 Liquid End Parts
 Model 811 - Small Frame - (Replaces 3196 ST / STX)**

Part	Item #	Qty Req.	Material	Griswold	Goulds
				Part #	Part #
Case	100	1	DI	21299-01-N6	104-422-1012
			316SS	21299-01-91	104-555-1203
			CD4MCu	21299-01-X4	104-555-1216
			Alloy 20	21299-01-20	104-555-1204
Impeller	101	1	DI	21293-20-N6	076778-1013
			316SS	21293-20-91	076792-1203
			CD4MCu	21293-20-X4	076792-1216
			Alloy 20	21293-20-20	076792-1204
Lantern Ring	105	1	Teflon	21414	R76775
Packing	106	1	Tef/Imp	21647-13-7	A01081A14
Plain Gland	107	1	316SS	21415-01-91	RB01049A1203
Stuffing Box - Standard Bore	184	1	DI	21284-01-N6	R104-429-1012
			316SS	21284-01-91	R104-562-1203
			CD4MCu	21284-01-X4	R104-562-1216
			Alloy 20	21284-01-20	R104-562-1204
Stuffing Box - Taper Bore	184	1	DI	24284-02-N6	RC01382A03-1012
			316SS	24284-02-91	RC01382A01-1203
			CD4MCu	24284-02-X4	RC01382A01-1216
			Alloy 20	24284-02-20	RC01382A01-1204
Flush Gland	250	1	Various	Various	Various
Case Gasket (15% Glass-Filled TFE) (FDA Approved)	351	1	EPDM	10399-53-03	70782-81-5127
			Teflon	10399-53-05	70782-81-5117
			Gylon	10399-53-06	70782-81-5118
Gland Stud	353	4	316 SS	21855-01-04	27177-588-2229
Gland Stud Nut	355	4	304 SS	3932-8	495074-2228
Capscrew Frame - Case	370	4	Steel	3861-167	49511-252-2210
Hex Bolts - Jacking	418	2	304 SS	14129613	49521-104-2228
Hex Nut - Stuffing Box Stud	357K	2	304SS	3932-82	495073-2228
Gland Gasket-STD Box	360Q	1	EPDM	18408-4	70782-25-5127
Stud - Stuffing Box	370H	2	304 SS	3862-83	27177-664-2228
Impeller O-Ring	412A	1	Teflon	18461-14-38	C02495A236359
Maintenance Kit	902	1	Various	K-3196S-6	R196-MKS6
Repair Kit	906A	1	Various	RK-3196S	R196STPRKO

Items in bold may or may not be in stock. Longer lead times may be required. RTF.

**3 X 2 X 6 Liquid End Parts
 Model 811 - Small Frame - (Replaces 3196 ST / STX)**

Part	Item #	Qty Req.	Material	Griswold	Goulds
				Part #	Part #
Case	100	1	DI	21331-01-N6	105-202-1012
			316SS	21331-01-91	105-204-1203
			CD4MCu	21331-01-X4	105-204-1216
			Alloy 20	21331-01-20	105-204-1204
Impeller	101	1	DI	21335-01-N6	0B10172-1013
			316SS	21335-01-91	0B10176-1203
			CD4MCu	21335-01-X4	0B10176-1216
			Alloy 20	21335-01-20	0B10176-1204
Lantern Ring	105	1	Teflon	21414	R76775
Packing	106	1	Tef/Imp	21647-13-7	A01081A14
Plain Gland	107	1	316SS	21415-01-91	RB01049A1203
Stuffing Box - Standard Bore	184	1	DI	21284-01-N6	R104-429-1012
			316SS	21284-01-91	R104-562-1203
			CD4MCu	21284-01-X4	R104-562-1216
			Alloy 20	21284-01-20	R104-562-1204
Stuffing Box - Taper Bore	184	1	DI	24284-02-N6	RC01382A03-1012
			316SS	24284-02-91	RC01382A01-1203
			CD4MCu	24284-02-X4	RC01382A01-1216
			Alloy 20	24284-02-20	RC01382A01-1204
Flush Gland	250	1	Various	Various	Various
Case Gasket (15% Glass-Filled TFE) (FDA Approved)	351	1	EPDM	10399-53-03	70782-81-5127
			Teflon	10399-53-05	70782-81-5117
			Gylon	10399-53-06	70782-81-5118
Gland Stud	353	4	316 SS	21855-01-04	27177-588-2229
Gland Stud Nut	355	4	304 SS	3932-8	495074-2228
Capscrew Frame - Case	370	4	Steel	3861-167	49511-252-2210
Hex Bolts - Jacking	418	2	304 SS	14129613	49521-104-2228
Hex Nut - Stuffing Box Stud	357K	2	304SS	3932-82	495073-2228
Gland Gasket-STD Box	360Q	1	EPDM	18408-4	70782-25-5127
Stud - Stuffing Box	370H	2	304 SS	3862-83	27177-664-2228
Impeller O-Ring	412A	1	Teflon	18461-14-38	C02495A236359
Maintenance Kit	902	1	Various	K-3196S-6	R196-MKS6
Repair Kit	906A	1	Various	RK-3196S	R196STPRKO

Items in bold may or may not be in stock. Longer lead times may be required. RTF.

**1 1/2 X 1 X 8 Liquid End Parts
 Model 811 - Small Frame - (Replaces 3196 ST / STX)**

Part	Item #	Qty Req.	Material	Griswold	Goulds
				Part #	Part #
Case	100	1	DI	21426-01-N6	104-423-1012
			316SS	21426-01-91	104-556-1203
			CD4MCu	21426-01-X4	104-556-1216
			Alloy 20	21426-01-20	104-556-1204
Impeller	101	1	DI	21280-40-N6	076779-1013
			316SS	21280-40-91	076793-1203
			CD4MCu	21280-40-X4	076793-1216
			Alloy 20	21280-40-20	076793-1204
Lantern Ring	105	1	Teflon	21414	R76775
Packing	106	1	Tef/Imp	21647-13-7	A01081A14
Plain Gland	107	1	316SS	21415-01-91	RB01049A1203
Stuffing Box - Standard Bore	184	1	DI	21417-01-N6	R104-431-1012
			316SS	21417-01-91	R104-564-1203
			CD4MCu	21417-01-X4	R104-564-1216
			Alloy 20	21417-01-20	R104-564-1204
Stuffing Box - Taper Bore	184	1	DI	24417-02-N6	RC01382A09-1012
			316SS	24417-02-91	RC01382A07-1203
			CD4MCu	24417-02-X4	RC01382A07-1216
			Alloy 20	24417-02-20	RC01382A07-1204
Flush Gland	250	1	Various	Various	Various
Case Gasket (15% Glass-Filled TFE) (FDA Approved)	351	1	EPDM	10399-52-03	70782-82-5127
			Teflon	10399-52-05	70782-82-5117
			Gylon	10399-52-06	70782-82-5118
Gland Stud	353	4	316 SS	21855-01-04	27177-588-2229
Gland Stud Nut	355	4	304 SS	3932-8	495074-2228
Capscrew Frame - Case	370	4	Steel	3861-167	49511-252-2210
Hex Bolts - Jacking	418	2	304 SS	14129613	49521-104-2228
Hex Nut - Stuffing Box Stud	357K	2	304SS	3932-82	495073-2228
Gland Gasket-STD Box	360Q	1	EPDM	18408-4	70782-25-5127
Stud - Stuffing Box	370H	2	304 SS	3862-83	27177-664-2228
Impeller O-Ring	412A	1	Teflon	18461-14-38	C02495A236359
Maintenance Kit	902	1	Various	K-3196S-8	R196-MKS8
Repair Kit	906A	1	Various	RK-3196S	R196STPRKO

Items in bold may or may not be in stock. Longer lead times may be required. RTF.

**3 X 1 1/2 X 8 Liquid End Parts
 Model 811 - Small Frame - (Replaces 3196 ST / STX)**

Part	Item #	Qty Req.	Material	Griswold	Goulds
				Part #	Part #
Case	100	1	DI	21418-01-N6	104-424-1012
			316SS	21418-01-91	104-557-1203
			CD4MCu	21418-01-X4	104-557-1216
			Alloy 20	21418-01-20	104-557-1204
Impeller	101	1	DI	21281-40-N6	076780-1013
			316SS	21281-40-91	076794-1203
			CD4MCu	21281-40-X4	076794-1216
			Alloy 20	21281-40-20	076794-1204
Lantern Ring	105	1	Teflon	21414	R76775
Packing	106	1	Tef/Imp	21647-13-7	A01081A14
Plain Gland	107	1	316SS	21415-01-91	RB01049A1203
Stuffing Box - Standard Bore	184	1	DI	21417-01-N6	R104-431-1012
			316SS	21417-01-91	R104-564-1203
			CD4MCu	21417-01-X4	R104-564-1216
			Alloy 20	21417-01-20	R104-564-1204
Stuffing Box - Taper Bore	184	1	DI	24417-02-N6	RC01382A09-1012
			316SS	24417-02-91	RC01382A07-1203
			CD4MCu	24417-02-X4	RC01382A07-1216
			Alloy 20	24417-02-20	RC01382A07-1204
Flush Gland	250	1	Various	Various	Various
Case Gasket (15% Glass-Filled TFE) (FDA Approved)	351	1	EPDM	10399-52-03	70782-82-5127
			Teflon	10399-52-05	70782-82-5117
			Gylon	10399-52-06	70782-82-5118
Gland Stud	353	4	316 SS	21855-01-04	27177-588-2229
Gland Stud Nut	355	4	304 SS	3932-8	495074-2228
Capscrew Frame - Case	370	4	Steel	3861-167	49511-252-2210
Hex Bolts - Jacking	418	2	304 SS	14129613	49521-104-2228
Hex Nut - Stuffing Box Stud	357K	2	304SS	3932-82	495073-2228
Gland Gasket-STD Box	360Q	1	EPDM	18408-4	70782-25-5127
Stud - Stuffing Box	370H	2	304 SS	3862-83	27177-664-2228
Impeller O-Ring	412A	1	Teflon	18461-14-38	C02495A236359
Maintenance Kit	902	1	Various	K-3196S-8	R196-MKS8
Repair Kit	906A	1	Various	RK-3196S	R196STPRKO

Items in bold may or may not be in stock. Longer lead times may be required. RTF.

**3 X 2 X 6 Liquid End Parts
 Model 811 - Medium Frame - (Replaces 3196 MT / MTX)**

Part	Item #	Qty Req.	Material	Griswold Part #	Goulds Part #
Case	100	1	DI	23018-01-N6	247-36-1012
			316SS	23018-01-91	247-35-1203
			CD4MCu	23018-01-X4	247-35-1216
			Alloy 20	23018-01-20	247-35-1204
Impeller	101	1	DI	23020-20-N6	0100-156-1013
			316SS	23020-20-91	0100-155-1203
			CD4MCu	23020-20-X4	0100-155-1216
			Alloy 20	23020-20-20	0100-155-1204
Lantern Ring	105	1	Teflon	21275	R76293
Packing	106	1	Kevlar	21647-16-4	A01081A06
Plain Gland	107	1	316 SS	21277-0-91	RB01050A-1203
Stuffing Box - Standard Bc	184	1	DI	23024-01-N6	R100-107-1012
			316SS	23024-01-91	R100-786-1203
			CD4MCu	23024-01-X4	R100-786-1216
			Alloy 20	23024-01-20	R100-786-1240
Flush Gland	250	1	Various	Various	Various
Case Gasket (15% Glass-Filled TFE) (FDA Approved)	351	1	EPDM	10399-54-03	70782-19-5127
			Teflon	10399-54-05	70782-19-5117
			Gylon	10399-54-06	70782-19-5118
Gland Stud	353	2	316 SS	21855-02-04	27177-607-2229
Gland Stud Nut	355	2	304 SS	3932-62	495077-2228
Capscrew Frame - Case	370	8	Steel	3861-36	49511-252-2210
Hex Bolts - Jacking	418	3	Steel	3861-22	49521-204-2228
Hex Nut - Stuffing Box Stu	357K	2	304 SS	3932-82	495073-2228
Gasket, Frame To Adapter	360D	1	VELLUMOID	24400	73078-5130-0001
Gland Gasket-STD Box	360Q	1	EDPM	18408-5	70782-30-5127
Stud - Stuffing Box	370H	2	304 SS	21855-02-04	27177-715-2228
Impeller O-Ring	412A	1	Teflon	18461-15-38	C02495A286359
Maintenance Kit	902	1	Various	K-3196-M-6	R196-MKM6
Repair Kit	906A	1	Various	RK-3196M	R196MTPRKO

Items in bold may or may not be in stock. Longer lead times may be required. RTF.

**4 X 3 X 7 Liquid End Parts
 Model 811 - Medium Frame - (Replaces 3196 MT / MTX)**

Part	Item #	Qty Req.	Material	Griswold Part #	Goulds Part #
Case	100	1	DI	N/A	D00247A01-1012
			316SS	N/A	D00247A02-1203
			CD4MCu	N/A	D00247A02-1216
			Alloy 20	N/A	D00247A02-1204
Impeller	101	1	DI	N/A	0C00143A01-1013
			316SS	N/A	0C00143A02-1203
			CD4MCu	N/A	0C00143A02-1216
			Alloy 20	N/A	0C00143A02-1204
Lantern Ring	105	1	Teflon	21275	R76293
Packing	106	1	Kevlar	21647-16-4	A01081A06
Plain Gland	107	1	316 SS	21277-0-91	RB01050A-1203
Adapter	108	1	DI	24286-01-N6	262-92-1013
Stuffing Box - Standard Bore	184	1	DI	21550-01-N6	R100-111-1012
			316SS	21550-01-91	R100-788-1203
			CD4MCu	21550-01-X4	R100-788-1216
			Alloy 20	21550-01-20	R100-788-1204
Stuffing Box - Taper Bore	184	1	DI	24550-02-N6	RC04047A-1012
			316SS	24550-02-91	RC04109A01-1203
			CD4MCu	24550-02-X4	RC04109A01-1216
			Alloy 20	24550-02-20	RC04109A01-1204
Flush Gland	250	1	Various	Various	Various
Case Gasket (15% Glass-Filled TFE) (FDA Approved)	351	1	EPDM	10399-51-03	70782-20-5127
			Teflon	10399-51-05	70782-20-5117
			Gylon	10399-51-06	70782-20-5118
Gland Stud	353	2	316 SS	21855-02-04	27177-607-2229
Gland Stud Nut	355	2	304 SS	3932-62	495077-2228
Capscrew Frame - Case	370	8	Steel	3861-36	49511252-2210
Hex Bolts - Jacking	418	3	Steel	3861-22	49521-204-2228
Hex Nut - Stuffing Box Stud	357K	2	304 SS	3932-82	495073-2228
Gasket, Frame To Adapter	360D	1	VELLUMOID	24400	73078-5130-0001
Gland Gasket-STD Box	360Q	1	EDPM	18408-5	70782-30-5127
Stud - Stuffing Box	370H	2	304 SS	21855-02-04	27177-715-2228
Impeller O-Ring	412A	1	Teflon	18461-15-38	C02495A286359
Maintenance Kit	902	1	Various	K-3196M-8	R196-MKM8
Repair Kit	906A	1	Various	RK-3196M	R196MTPRKO

Items in bold may or may not be in stock. Longer lead times may be required. RTF.

Griswold Pump Company - 107 Plantation Oak Drive - Thomasville, Georgia 31792
 Phone (229) 226-5255 - (800) 843-9222 Fax (229) 226-5567 - (800) 752-2929

**3 X 2 X 8 Liquid End Parts
 Model 811 - Medium Frame - (Replaces 3196 MT / MTX)**

Part	Item #	Qty Req.	Material	Griswold Part #	Goulds Part #
Case	100	1	DI	21336-01-N6	247-42-1012
			316SS	21336-01-91	247-41-1203
			CD4MCu	21336-01-X4	247-41-1216
			Alloy 20	21336-01-20	247-41-1204
Impeller	101	1	DI	21328-43-N6	0100-162-1013
			316SS	21328-43-91	0100-161-1203
			CD4MCu	21328-43-X4	0100-161-1216
			Alloy 20	21328-43-20	0100-161-1204
Lantern Ring	105	1	Teflon	21275	R76293
Packing	106	1	Kevlar	21647-16-4	A01081A06
Plain Gland	107	1	316 SS	21277-0-91	RB01050A-1203
Adapter	108	1	DI	24286-01-N6	262-92-1013
Stuffing Box - Standard Bore	184	1	DI	21550-01-N6	R100-111-1012
			316SS	21550-01-91	R100-788-1203
			CD4MCu	21550-01-X4	R100-788-1216
			Alloy 20	21550-01-20	R100-788-1204
Stuffing Box - Taper Bore	184	1	DI	24550-02-N6	RC04047A-1012
			316SS	24550-02-91	RC04109A01-1203
			CD4MCu	24550-02-X4	RC04109A01-1216
			Alloy 20	24550-02-20	RC04109A01-1204
Flush Gland	250	1	Various	Various	Various
Case Gasket (15% Glass-Filled TFE) (FDA Approved)	351	1	EPDM	10399-51-03	70782-20-5127
			Teflon	10399-51-05	70782-20-5117
			Gylon	10399-51-06	70782-20-5118
Gland Stud	353	2	316 SS	21855-02-04	27177-607-2229
Gland Stud Nut	355	2	304 SS	3932-62	495077-2228
Capscrew Frame - Case	370	8	Steel	3861-36	49511-252-2210
Hex Bolts - Jacking	418	3	Steel	3861-22	49521-204-2228
Hex Nut - Stuffing Box Stud	357K	2	304 SS	3932-82	495073-2228
Gasket, Frame To Adapter	360D	1	VELLUMOID	24400	73078-5130-0001
Gland Gasket-STD Box	360Q	1	EDPM	18408-5	70782-30-5127
Stud - Stuffing Box	370H	2	304 SS	21855-02-04	27177-715-2228
Impeller O-Ring	412A	1	Teflon	18461-15-38	C02495A286359
Maintenance Kit	902	1	Various	K-3196M-8	R196-MKM8
Repair Kit	906A	1	Various	RK-3196M	R196MTPRKO

Items in bold may or may not be in stock. Longer lead times may be required. RTF.

Griswold Pump Company - 107 Plantation Oak Drive - Thomasville, Georgia 31792
 Phone (229) 226-5255 - (800) 843-9222 Fax (229) 226-5567 - (800) 752-2929

**4 X 3 X 8 Liquid End Parts
 Model 811 - Medium Frame - (Replaces 3196 MT / MTX)**

Part	Item #	Qty Req.	Material	Griswold Part #	Goulds Part #
Case	100	1	DI	21005-01-N6	247-44-1012
			316SS	21005-01-91	247-43-1203
			CD4MCu	21005-01-X4	247-43-1216
			Alloy 20	21005-01-20	247-43-1204
Impeller	101	1	DI	21338-40-N6	0100-164-1013
			316SS	21338-40-91	0100-163-1203
			CD4MCu	21338-40-X4	0100-163-1216
			Alloy 20	21338-40-20	0100-163-1204
Lantern Ring	105	1	Teflon	21275	R76293
Packing	106	1	Kevlar	21647-16-4	A01081A06
Plain Gland	107	1	316 SS	21277-0-91	RB01050A-1203
Adapter	108	1	DI	24286-01-N6	262-92-1013
Stuffing Box - Standard Bore	184	1	DI	21550-01-N6	R100-111-1012
			316SS	21550-01-91	R100-788-1203
			CD4MCu	21550-01-X4	R100-788-1216
			Alloy 20	21550-01-20	R100-788-1204
Stuffing Box - Taper Bore	184	1	DI	24550-02-N6	RC04047A-1012
			316SS	24550-02-91	RC04109A01-1203
			CD4MCu	24550-02-X4	RC04109A01-1216
			Alloy 20	24550-02-20	RC04109A01-1204
Flush Gland	250	1	Various	Various	Various
Case Gasket (15% Glass-Filled TFE) (FDA Approved)	351	1	EPDM	10399-51-03	70782-20-5127
			Teflon	10399-51-05	70782-20-5117
			Gylon	10399-51-06	70782-20-5118
Gland Stud	353	2	316 SS	21855-02-04	27177-607-2229
Gland Stud Nut	355	2	304 SS	3932-62	495077-2228
Capscrew Frame - Case	370	8	Steel	3861-36	49511-252-2210
Hex Bolts - Jacking	418	3	Steel	3861-22	49521-204-2228
Hex Nut - Stuffing Box Stud	357K	2	304 SS	3932-82	495073-2228
Gasket, Frame To Adapter	360D	1	VELLUMOID	24400	73078-5130-0001
Gland Gasket-STD Box	360Q	1	EDPM	18408-5	70782-30-5127
Stud - Stuffing Box	370H	2	304 SS	21855-02-04	27177-715-2228
Impeller O-Ring	412A	1	Teflon	18461-15-38	C02495A286359
Maintenance Kit	902	1	Various	K-3196M-8	R196-MKM8
Repair Kit	906A	1	Various	RK-3196M	R196MTPRKO

Items in bold may or may not be in stock. Longer lead times may be required. RTF.

**4 X 3 X 8 G Liquid End Parts
 Model 811 - Medium Frame - (Replaces 3196 MT / MTX)**

Part	Item #	Qty Req.	Material	Griswold Part #	Goulds Part #
Case	100	1	DI	21004-01-N6	247-46-1012
			316SS	21004-01-91	247-45-1203
			CD4MCu	21004-01-X4	247-45-1216
			Alloy 20	21004-01-20	247-45-1204
Impeller	101	1	DI	21337-40-N6	0100-166-1013
			316SS	21337-40-91	0100-165-1203
			CD4MCu	21337-40-X4	0100-165-1216
			Alloy 20	21337-40-20	0100-165-1204
Lantern Ring	105	1	TEFLN	21275	R76293
Packing	106	1	Kevlar	21647-16-4	A01081A06
Plain Gland	107	1	316 SS	21277-0-91	RB01050A-1203
Adapter	108	1	DI	24286-01-N6	262-92-1013
Stuffing Box - Standard Bore	184	1	DI	21550-01-N6	R100-111-1012
			316SS	21550-01-91	R100-788-1203
			CD4MCu	21550-01-X4	R100-788-1216
			Alloy 20	21550-01-20	R100-788-1204
Stuffing Box - Taper Bore	184	1	DI	24550-02-N6	RC04047A-1012
			316SS	24550-02-91	RC04109A01-1203
			CD4MCu	24550-02-X4	RC04109A01-1216
			Alloy 20	24550-02-20	RC04109A01-1204
Flush Gland	250	1	Various	Various	Various
Case Gasket (15% Glass-Filled TFE) (FDA Approved)	351	1	EPDM	10399-51-03	70782-20-5127
			Teflon	10399-51-05	70782-20-5117
			Gylon	10399-51-06	70782-20-5118
Gland Stud	353	2	316 SS	21855-02-04	27177-607-2229
Gland Stud Nut	355	2	304 SS	3932-62	495077-2228
Capscrew Frame - Case	370	8	STEEL	3861-36	49511-252-2210
Hex Bolts - Jacking	418	3	Steel	3861-22	49521-204-2228
Hex Nut - Stuffing Box Stud	357K	2	316 SS	3932-82	495073-2228
Gasket, Frame To Adapter	360D	1	VELLUMOID	24400	73078-5130-0001
Gland Gasket-STD Box	360Q	1	EDPM	18408-5	70782-30-5127
Stud - Stuffing Box	370H	2	304 SS	21855-02-04	27177-715-2228
Impeller O-Ring	412A	1	TEFLN	18461-15-38	C02495A286359
Maintenance Kit	902	1	Various	K-3196M-8	R196-MKM8
Repair Kit	906A	1	Various	RK-3196M	R196MTPRKO

Items in bold may or may not be in stock. Longer lead times may be required. RTF.

**2 X 1 X 10 Liquid End Parts
 Model 811 - Medium Frame - (Replaces 3196 MT / MTX)**

Part	Item #	Qty Req.	Material	Griswold Part #	Goulds Part #
Case	100	1	DI	21334-01-N6	104-445-1012
			316SS	21334-01-91	104-878-1203
			CD4MCu	21334-01-X4	104-878-1216
			Alloy 20	21334-01-20	104-878-1204
Impeller	101	1	DI	21329-60-N6	076797-1013
			316SS	21329-60-91	0B10009-1203
			CD4MCu	21329-60-X4	0B10009-1216
			Alloy 20	21329-60-20	0B10009-1204
Lantern Ring	105	1	Teflon	21275	R76293
Packing	106	1	Kevlar	21647-16-4	A01081A06
Plain Gland	107	1	316 SS	21277-0-91	RB01050A-1203
Adapter	108	1	DI	24285-01-N6	262-93-1013
Stuffing Box - Standard Bore	184	1	DI	21279-01-N6	R100-586-1012
			316SS	21279-01-91	R100-585-1203
			CD4MCu	21279-01-X4	R100-585-1216
			Alloy 20	21279-01-20	R100-585-1204
Stuffing Box - Taper Bore			DI	24279-02-N6	RC04048A-1012
			316SS	24279-02-91	RC04110A01-1203
			CD4MCu	24279-02-X4	RC04110A01-1216
			Alloy 20	24279-02-20	RC04110A01-1204
Flush Gland	250	1	Various	Various	Various
Case Gasket (15% Glass-Filled TFE) (FDA Approved)	351	1	EPDM	10399-50-03	70782-29-5127
			Teflon	10399-50-05	70782-29-5117
			Gylon	10399-50-06	70782-29-5118
Gland Stud	353	2	316 SS	21855-02-04	27177-607-2229
Gland Stud Nut	355	2	304 SS	3932-62	495077-2228
Capscrew Frame - Case	370	12	Steel	3861-36	49511-252-2210
Hex Bolts - Jacking	418	3	Steel	3861-22	49521-204-2228
Hex Nut - Stuffing Box Stud	357K	2	304 SS	3932-82	495073-2228
Gasket, Frame To Adapter	360D	1	VELLUMOID	24400	73078-5130-0001
Gland Gasket-STD Box	360Q	1	EDPM	18408-5	70782-30-5127
Stud - Stuffing Box	370H	2	304 SS	21855-02-04	27177-715-2228
Impeller O-Ring	412A	1	Teflon	18461-15-38	C02495A286359
Maintenance Kit	902	1	Various	K-3196M-10	R196-MKM10
Repair Kit	906A	1	Various	RK-3196M	R196MTPRKO

Items in bold may or may not be in stock. Longer lead times may be required. RTF.

**3 X 1 1/2 X 10 Liquid End Parts
 Model 811 - Medium Frame - (Replaces 3196 MT / MTX)**

Part	Item #	Qty Req.	Material	Griswold Part #	Goulds Part #
Case	100	1	DI	21271-01-N6	249-54-1012
			316SS	21271-01-91	249-60-1203
			CD4MCu	21271-01-X4	249-60-1216
			Alloy 20	21271-01-20	249-60-1204
Impeller	101	1	DI	21272-60-N6	0100-594-1013
			316SS	21272-60-91	0100-593-1203
			CD4MCu	21272-60-X4	0100-593-1216
			Alloy 20	21272-60-20	0100-593-1204
Lantern Ring	105	1	Teflon	21275	R76293
Packing	106	1	Kevlar	21647-16-4	A01081A06
Plain Gland	107	1	316 SS	21277-0-91	RB01050A-1203
Adapter	108	1	DI	24285-01-N6	262-93-1013
Stuffing Box - Standard Bore	184	1	DI	21279-01-N6	R100-586-1012
			316SS	21279-01-91	R100-585-1203
			CD4MCu	21279-01-X4	R100-585-1216
			Alloy 20	21279-01-20	R100-585-1204
Stuffing Box - Taper Bore			DI	24279-02-N6	RC04048A-1012
			316SS	24279-02-91	RC04110A01-1203
			CD4MCu	24279-02-X4	RC04110A01-1216
			Alloy 20	24279-02-20	RC04110A01-1204
Flush Gland	250	1	Various	Various	Various
Case Gasket (15% Glass-Filled TFE) (FDA Approved)	351	1	EPDM	10399-50-03	70782-29-5127
			Teflon	10399-50-05	70782-29-5117
			Gylon	10399-50-06	70782-29-5118
Gland Stud	353	2	316 SS	21855-02-04	27177-607-2229
Gland Stud Nut	355	2	304 SS	3932-62	495077-2228
Capscrew Frame - Case	370	12	Steel	3861-36	49511252-2210
Hex Bolts - Jacking	418	3	Steel	3861-22	49521-204-2228
Hex Nut - Stuffing Box Stud	357K	2	304 SS	3932-82	495073-2228
Gasket, Frame To Adapter	360D	1	VELLUMOID	24400	73078-5130-0001
Gland Gasket-STD Box	360Q	1	EDPM	18408-5	70782-30-5127
Stud - Stuffing Box	370H	2	304 SS	21855-02-04	27177-715-2228
Impeller O-Ring	412A	1	Teflon	18461-15-38	C02495A286359
Maintenance Kit	902	1	Various	K-3196M-10	R196-MKM10
Repair Kit	906A	1	Various	RK-3196M	R196MTPRKO

Items in bold may or may not be in stock. Longer lead times may be required. RTF.

**3 X 2 X 10 Liquid End Parts
 Model 811 - Medium Frame - (Replaces 3196 MT / MTX)**

Part	Item #	Qty Req.	Material	Griswold Part #	Goulds Part #
Case	100	1	DI	21327-01-N6	249-55-1012
			316SS	21327-01-91	249-61-1203
			CD4MCu	21327-01-X4	249-61-1216
			Alloy 20	21327-01-20	249-61-1204
Impeller	101	1	DI	21422-60-N6	0100-596-1013
			316SS	21422-60-91	0100-595-1203
			CD4MCu	21422-60-X4	0100-595-1216
			Alloy 20	21422-60-20	0100-595-1204
Lantern Ring	105	1	Teflon	21275	R76293
Packing	106	1	Kevlar	21647-16-4	A01081A06
Plain Gland	107	1	316 SS	21277-0-91	RB01050A-1203
Adapter	108	1	DI	24285-01-N6	262-93-1013
Stuffing Box - Standard Bore	184	1	DI	21279-01-N6	R100-586-1012
			316SS	21279-01-91	R100-585-1203
			CD4MCu	21279-01-X4	R100-585-1216
			Alloy 20	21279-01-20	R100-585-1204
Stuffing Box - Taper Bore	184	1	DI	24279-02-N6	RC04048A-1012
			316SS	24279-02-91	RC04110A01-1203
			CD4MCu	24279-02-X4	RC04110A01-1216
			Alloy 20	24279-02-20	RC04110A01-1204
Flush Gland	250	1	Various	Various	Various
Case Gasket (15% Glass-Filled TFE) (FDA Approved)	351	1	EPDM	10399-50-03	70782-29-5127
			Teflon	10399-50-05	70782-29-5117
			Gylon	10399-50-06	70782-29-5118
Gland Stud	353	2	316 SS	21855-02-04	27177-607-2229
Gland Stud Nut	355	2	304 SS	3932-62	495077-2228
Capscrew Frame - Case	370	12	Steel	3861-36	49511252-2210
Hex Bolts - Jacking	418	3	Steel	3861-22	49521-204-2228
Hex Nut - Stuffing Box Stud	357K	2	304 SS	3932-82	495073-2228
Gasket, Frame To Adapter	360D	1	VELLUMOID	24400	73078-5130-0001
Gland Gasket-STD Box	360Q	1	EDPM	18408-5	70782-30-5127
Stud - Stuffing Box	370H	2	304 SS	21855-02-04	27177-715-2228
Impeller O-Ring	412A	1	Teflon	18461-15-38	C02495A286359
Maintenance Kit	902	1	Various	K-3196M-10	R196-MKM10
Repair Kit	906A	1	Various	RK-3196M	R196MTPRKO

Items in bold may or may not be in stock. Longer lead times may be required. RTF.

**4 X 3 X 10 Liquid End Parts
 Model 811 - Medium Frame - (Replaces 3196 MT / MTX)**

Part	Item #	Qty Req.	Material	Griswold Part #	Goulds Part #
Case	100	1	DI	21274-01-N6	249-56-1012
			316SS	21274-01-91	249-62-1203
			CD4MCu	21274-01-X4	249-62-1216
			Alloy 20	21274-01-20	249-62-1204
Impeller	101	1	DI	21273-60-N6	0100-598-1013
			316SS	21273-60-91	0100-597-1203
			CD4MCu	21273-60-X4	0100-597-1216
			Alloy 20	21273-60-20	0100-597-1204
Lantern Ring	105	1	Teflon	21275	R76293
Packing	106	1	Kevlar	21647-16-4	A01081A06
Plain Gland	107	1	316 SS	21277-0-91	RB01050A-1203
Adapter	108	1	DI	24285-01-N6	262-93-1013
Stuffing Box - Standard Bore	184	1	DI	21279-01-N6	R100-586-1012
			316SS	21279-01-91	R100-585-1203
			CD4MCu	21279-01-X4	R100-585-1216
			Alloy 20	21279-01-20	R100-585-1204
Stuffing Box - Taper Bore	184	1	DI	24279-02-N6	RC04048A-1012
			316SS	24279-02-91	RC04110A01-1203
			CD4MCu	24279-02-X4	RC04110A01-1216
			Alloy 20	24279-02-20	RC04110A01-1204
Flush Gland	250	1	Various	Various	Various
Case Gasket (15% Glass-Filled TFE) (FDA Approved)	351	1	EPDM	10399-50-03	70782-29-5127
			Teflon	10399-50-05	70782-29-5117
			Gylon	10399-50-06	70782-29-5118
Gland Stud	353	2	316 SS	21855-02-04	27177-607-2229
Gland Stud Nut	355	2	304 SS	3932-62	495077-2228
Capscrew Frame - Case	370	12	Steel	3861-36	49511-252-2210
Hex Bolts - Jacking	418	3	Steel	3861-22	49521-204-2228
Hex Nut - Stuffing Box Stud	357K	2	304 SS	3932-82	495073-2228
Gasket, Frame To Adapter	360D	1	VELLUMOID	24400	73078-5130-0001
Gland Gasket-STD Box	360Q	1	EDPM	18408-5	70782-30-5127
Stud - Stuffing Box	370H	2	304 SS	21855-02-04	27177-715-2228
Impeller O-Ring	412A	1	Teflon	18461-15-38	C02495A286359
Maintenance Kit	902	1	Various	K-3196M-10	R196-MKM10
Repair Kit	906A	1	Various	RK-3196M	R196MTPRKO

Items in bold may or may not be in stock. Longer lead times may be required. RTF.

**4 X 3 X 10H Liquid End Parts
 Model 811 - Medium Frame - (Replaces 3196 MT / MTX)**

Part	Item #	Qty Req.	Material	Griswold Part #	Goulds Part #
Case	100	1	DI	21006-01-N6	D00452A01-1012
			316SS	21006-01-91	D00452A02-1203
			CD4MCu	21006-01-X4	D00452A02-1216
			Alloy 20	21006-01-20	D00452A02-1204
Impeller	101	1	DI	21275-60-N6	0C00262A01-1013
			316SS	21275-60-91	0C00262A02-1203
			CD4MCu	21275-60-X4	0C00262A02-1216
			Alloy 20	21275-60-20	0C00262A02-1204
Lantern Ring	105	1	Teflon	21275	R76293
Packing	106	1	Kevlar	21647-16-4	A01081A06
Plain Gland	107	1	316 SS	21277-0-91	RB01050A-1203
Adapter	108	1	DI	24285-01-N6	262-93-1013
Stuffing Box - Standard Bore	184	1	DI	21279-01-N6	R100-586-1012
			316SS	21279-01-91	R100-585-1203
			CD4MCu	21279-01-X4	R100-585-1216
			Alloy 20	21279-01-20	R100-585-1204
Stuffing Box - Taper Bore	184	1	DI	24279-02-N6	RC04048A-1012
			316SS	24279-02-91	RC04110A01-1203
			CD4MCu	24279-02-X4	RC04110A01-1216
			Alloy 20	24279-02-20	RC04110A01-1204
Flush Gland	250	1	Various	Various	Various
Case Gasket (15% Glass-Filled TFE) (FDA Approved)	351	1	EPDM	10399-50-03	70782-29-5127
			Teflon	10399-50-05	70782-29-5117
			Gylon	10399-50-06	70782-29-5118
Gland Stud	353	2	316 SS	21855-02-04	27177-607-2229
Gland Stud Nut	355	2	304 SS	3932-62	495077-2228
Capscrew Frame - Case	370	12	Steel	3861-36	49511-252-2210
Hex Bolts - Jacking	418	3	Steel	3861-22	49521-204-2228
Hex Nut - Stuffing Box Stud	357K	2	304 SS	3932-82	495073-2228
Gasket, Frame To Adapter	360D	1	VELLUMOID	24400	73078-5130-0001
Gland Gasket-STD Box	360Q	1	EDPM	18408-5	70782-30-5127
Stud - Stuffing Box	370H	2	304 SS	21855-02-04	27177-715-2228
Impeller O-Ring	412A	1	Teflon	18461-15-38	C02495A286359
Maintenance Kit	902	1	Various	K-3196M-10	R196-MKM10
Repair Kit	906A	1	Various	RK-3196M	R196MTPRKO

Items in bold may or may not be in stock. Longer lead times may be required. RTF.

Griswold Pump Company - 107 Plantation Oak Drive - Thomasville, Georgia 31792
 Phone (229) 226-5255 - (800) 843-9222 Fax (229) 226-5567 - (800) 752-2929

**6 X 4 X 10 Liquid End Parts
 Model 811 - Medium Frame - (Replaces 3196 MT / MTX)**

Part	Item #	Qty Req.	Material	Griswold Part #	Goulds Part #
Case	100	1	DI	21007-01-N6	251-91-1012
			316SS	21007-01-91	251-89-1203
			CD4MCu	21007-01-X4	251-89-1216
			Alloy 20	21007-01-20	251-89-1204
Impeller	101	1	DI	21373-60-N6	0101-527-1013
			316SS	21373-60-91	0101-528-1203
			CD4MCu	21373-60-X4	0101-528-1216
			Alloy 20	21373-60-20	0101-528-1204
Lantern Ring	105	1	Teflon	21275	R76293
Packing	106	1	Kevlar	21647-16-4	A01081A06
Plain Gland	107	1	316 SS	21277-0-91	RB01050A-1203
Adapter	108	1	DI	24285-01-N6	262-93-1013
Stuffing Box - Standard Bore	184	1	DI	21279-01-N6	R100-586-1012
			316SS	21279-01-91	R100-585-1203
			CD4MCu	21279-01-X4	R100-585-1216
			Alloy 20	21279-01-20	R100-585-1204
Stuffing Box - Taper Bore	184	1	DI	24279-02-N6	RC04048A-1012
			316SS	24279-02-91	RC04110A01-1203
			CD4MCu	24279-02-X4	RC04110A01-1216
			Alloy 20	24279-02-20	RC04110A01-1204
Flush Gland	250	1	Various	Various	Various
Case Gasket (15% Glass-Filled TFE) (FDA Approved)	351	1	EPDM	10399-50-03	70782-29-5127
			Teflon	10399-50-05	70782-29-5117
			Gylon	10399-50-06	70782-29-5118
Gland Stud	353	2	316 SS	21855-02-04	27177-607-2229
Gland Stud Nut	355	2	304 SS	3932-62	495077-2228
Capscrew Frame - Case	370	12	Steel	3861-36	49511-252-2210
Hex Bolts - Jacking	418	3	Steel	3861-22	49521-204-2228
Hex Nut - Stuffing Box Stud	357K	2	304 SS	3932-82	495073-2228
Gasket, Frame To Adapter	360D	1	VELLUMOID	24400	73078-5130-0001
Gland Gasket-STD Box	360Q	1	EDPM	18408-5	70782-30-5127
Stud - Stuffing Box	370H	2	304 SS	21855-02-04	27177-715-2228
Impeller O-Ring	412A	1	Teflon	18461-15-38	C02495A286359
Maintenance Kit	902	1	Various	K-3196M-10	R196-MKM10
Repair Kit	906A	1	Various	RK-3196M	R196MTPRKO

Items in bold may or may not be in stock. Longer lead times may be required. RTF.

Griswold Pump Company - 107 Plantation Oak Drive - Thomasville, Georgia 31792
 Phone (229) 226-5255 - (800) 843-9222 Fax (229) 226-5567 - (800) 752-2929

**6 X 4 X 10 G Liquid End Parts
 Model 811 - Medium Frame - (Replaces 3196 MT / MTX)**

Part	Item #	Qty Req.	Material	Griswold Part #	Goulds Part #
Case	100	1	DI	21008-01-N6	D08740A-1012
			316SS	21008-01-91	D08742A-1203
			CD4MCu	21008-01-X4	D08742A-1216
			Alloy 20	21008-01-20	D08742A-1204
Impeller	101	1	DI	21374-60-N6	C06348A-1013
			316SS	21374-60-91	C06349A-1203
			CD4MCu	21374-60-X4	C06349A-1216
			Alloy 20	21374-60-20	C06349A-1204
Lantern Ring	105	1	Teflon	21275	R76293
Packing	106	1	Kevlar	21647-16-4	A01081A06
Plain Gland	107	1	316 SS	21277-0-91	RB01050A-1203
Adapter	108	1	DI	24285-01-N6	262-93-1013
Stuffing Box - Standard Bore	184	1	DI	21279-01-N6	R100-586-1012
			316SS	21279-01-91	R100-585-1203
			CD4MCu	21279-01-X4	R100-585-1216
			Alloy 20	21279-01-20	R100-585-1204
Stuffing Box - Taper Bore	184	1	DI	24279-02-N6	RC04048A-1012
			316SS	24279-02-91	RC04110A01-1203
			CD4MCu	24279-02-X4	RC04110A01-1216
			Alloy 20	24279-02-20	RC04110A01-1204
Flush Gland	250	1	Various	Various	Various
Case Gasket (15% Glass-Filled TFE) (FDA Approved)	351	1	EPDM	10399-50-03	70782-29-5127
			Teflon	10399-50-05	70782-29-5117
			Gylon	10399-50-06	70782-29-5118
Gland Stud	353	2	316 SS	21855-02-04	27177-607-2229
Gland Stud Nut	355	2	304 SS	3932-62	495077-2228
Capscrew Frame - Case	370	12	Steel	3861-36	49511-252-2210
Hex Bolts - Jacking	418	3	Steel	3861-22	49521-204-2228
Hex Nut - Stuffing Box Stud	357K	2	304 SS	3932-82	495073-2228
Gasket, Frame To Adapter	360D	1	VELLUMOID	24400	73078-5130-0001
Gland Gasket-STD Box	360Q	1	EDPM	18408-5	70782-30-5127
Stud - Stuffing Box	370H	2	304 SS	21855-02-04	27177-715-2228
Impeller O-Ring	412A	1	Teflon	18461-15-38	C02495A286359
Maintenance Kit	902	1	Various	K-3196M-10	R196-MKM10
Repair Kit	906A	1	Various	RK-3196M	R196MTPRKO

Items in bold may or may not be in stock. Longer lead times may be required. RTF.

**6 X 4 X 10 H Liquid End Parts
 Model 811 - Medium Frame - (Replaces 3196 MT / MTX)**

Part	Item #	Qty Req.	Material	Griswold Part #	Goulds Part #
Case	100	1	DI	21009-01-N6	D03194A-1012
			316SS	21009-01-91	D03123A-1203
			CD4MCu	21009-01-X4	D03123A-1216
			Alloy 20	21009-01-20	D03123A-1204
Impeller	101	1	DI	21375-60-N6	0C02478A-1013
			316SS	21375-60-91	0C02521A-1203
			CD4MCu	21375-60-X4	0C02521A-1216
			Alloy 20	21375-60-20	0C02521A-1204
Lantern Ring	105	1	Teflon	21275	R76293
Packing	106	1	Kevlar	21647-16-4	A01081A06
Plain Gland	107	1	316 SS	21277-0-91	RB01050A-1203
Adapter	108	1	DI	24285-01-N6	262-93-1013
Stuffing Box - Standard Bore	184	1	DI	21279-01-N6	R100-586-1012
			316SS	21279-01-91	R100-585-1203
			CD4MCu	21279-01-X4	R100-585-1216
			Alloy 20	21279-01-20	R100-585-1204
Stuffing Box - Taper Bore	184	1	DI	24279-02-N6	RC04048A-1012
			316SS	24279-02-91	RC04110A01-1203
			CD4MCu	24279-02-X4	RC04110A01-1216
			Alloy 20	24279-02-20	RC04110A01-1204
Flush Gland	250	1	Various	Various	Various
Case Gasket (15% Glass-Filled TFE) (FDA Approved)	351	1	EPDM	10399-50-03	70782-29-5127
			Teflon	10399-50-05	70782-29-5117
			Gylon	10399-50-06	70782-29-5118
Gland Stud	353	2	316 SS	21855-02-04	27177-607-2229
Gland Stud Nut	355	2	304 SS	3932-62	495077-2228
Capscrew Frame - Case	370	12	Steel	3861-36	49511-252-2210
Hex Bolts - Jacking	418	3	Steel	3861-22	49521-204-2228
Hex Nut - Stuffing Box Stud	357K	2	304 SS	3932-82	495073-2228
Gasket, Frame To Adapter	360D	1	VELLUMOID	24400	73078-5130-0001
Gland Gasket-STD Box	360Q	1	EDPM	18408-5	70782-30-5127
Stud - Stuffing Box	370H	2	304 SS	21855-02-04	27177-715-2228
Impeller O-Ring	412A	1	Teflon	18461-15-38	C02495A286359
Maintenance Kit	902	1	Various	K-3196M-10	R196-MKM10
Repair Kit	906A	1	Various	RK-3196M	R196MTPRKO

Items in bold may or may not be in stock. Longer lead times may be required. RTF.

**3 X 1 1/2 X 13 Liquid End Parts
 Model 811 - Medium Frame - (Replaces 3196 MT / MTX)**

Part	Item #	Qty Req.	Material	Griswold Part #	Goulds Part #
Case	100	1	DI	21295-01-N6	249-57-1012
			316SS	21295-01-91	249-63-1203
			CD4MCu	21295-01-X4	249-63-1216
			Alloy 20	21295-01-20	249-63-1204
Impeller	101	1	DI	21283-90-N6	0100-538-1013
			316SS	21283-90-91	0100-537-1203
			CD4MCu	21283-90-X4	0100-537-1216
			Alloy 20	21283-90-20	0100-537-1204
Lantern Ring	105	1	Teflon	21275	R76293
Packing	106	1	Kevlar	21647-16-4	A01081A06
Plain Gland	107	1	316 SS	21277-0-91	RB01050A-1203
Adapter	108	1	DI	24291-01-N6	262-94-1013
Stuffing Box - Standard Bore	184	1	DI	21290-01-N6	R100-530-1012
			316SS	21290-01-91	R100-529-1203
			CD4MCu	21290-01-X4	R100-529-1216
			Alloy 20	21290-01-20	R100-529-1204
Stuffing Box - Taper Bore	184	1	DI	24290-02-N6	RC04049A-1012
			316SS	24290-02-91	RC04111A01-1203
			CD4MCu	24290-02-X4	RC04111A01-1216
			Alloy 20	24290-02-20	RC04111A01-1204
Flush Gland	250	1	Various	Various	Various
Case Gasket (15% Glass-Filled TFE) (FDA Approved)	351	1	EPDM	10399-49-03	70782-28-5127
			Teflon	10399-49-05	70782-28-5117
			Gylon	10399-49-06	70782-28-5118
Gland Stud	353	2	316 SS	21855-02-04	27177-607-2229
Gland Stud Nut	355	2	304 SS	3932-62	495077-2228
Capscrew Frame - Case	370	16	Steel	3861-36	49511-252-2210
Hex Bolts - Jacking	418	3	Steel	3861-22	49521-204-2228
Hex Nut - Stuffing Box Stud	357K	2	304 SS	3932-82	495073-2228
Gasket, Frame To Adapter	360D	1	VELLUMOID	24400	73078-5130-0001
Gland Gasket-STD Box	360Q	1	EDPM	18408-5	70782-30-5127
Stud - Stuffing Box	370H	2	304 SS	21855-02-04	27177-715-2228
Impeller O-Ring	412A	1	Teflon	18461-15-38	C02495A286359
Maintenance Kit	902	1	Various	K-3196M-13	R196-MKM13
Repair Kit	906A	1	Various	RK-3196M	R196MTPRKO

Items in bold may or may not be in stock. Longer lead times may be required. RTF.

Griswold Pump Company - 107 Plantation Oak Drive - Thomasville, Georgia 31792
 Phone (229) 226-5255 - (800) 843-9222 Fax (229) 226-5567 - (800) 752-2929

**3 X 2 X 13 Liquid End Parts
 Model 811 - Medium Frame - (Replaces 3196 MT / MTX)**

Part	Item #	Qty Req.	Material	Griswold Part #	Goulds Part #
Case	100	1	DI	21296-01-N6	D02451A-1012
			316SS	21296-01-91	D02450A-1203
			CD4MCu	21296-01-X4	D02450A-1216
			Alloy 20	21296-01-20	D02450A-1204
Impeller	101	1	DI	21423-90-N6	0100-540-1013
			316SS	21423-90-91	0100-539-1203
			CD4MCu	21423-90-X4	0100-539-1216
			Alloy 20	21423-90-20	0100-539-1204
Lantern Ring	105	1	Teflon	21275	R76293
Packing	106	1	Kevlar	21647-16-4	A01081A06
Plain Gland	107	1	316 SS	21277-0-91	RB01050A-1203
Adapter	108	1	DI	24291-01-N6	262-94-1013
Stuffing Box - Standard Bore	184	1	DI	21290-01-N6	R100-530-1012
			316SS	21290-01-91	R100-529-1203
			CD4MCu	21290-01-X4	R100-529-1216
			Alloy 20	21290-01-20	R100-529-1204
Stuffing Box - Taper Bore	184	1	DI	24290-02-N6	RC04049A-1012
			316SS	24290-02-91	RC04111A01-1203
			CD4MCu	24290-02-X4	RC04111A01-1216
			Alloy 20	24290-02-20	RC04111A01-1204
Flush Gland	250	1	Various	Various	Various
Case Gasket (15% Glass-Filled TFE) (FDA Approved)	351	1	EPDM	10399-49-03	70782-28-5127
			Teflon	10399-49-05	70782-28-5117
			Gylon	10399-49-06	70782-28-5118
Gland Stud	353	2	316 SS	21855-02-04	27177-607-2229
Gland Stud Nut	355	2	304 SS	3932-62	495077-2228
Capscrew Frame - Case	370	16	Steel	3861-36	49511-252-2210
Hex Bolts - Jacking	418	3	Steel	3861-22	49521-204-2228
Hex Nut - Stuffing Box Stud	357K	2	304 SS	3932-82	495073-2228
Gasket, Frame To Adapter	360D	1	VELLUMOIL	24400	73078-5130-0001
Gland Gasket-STD Box	360Q	1	EDPM	18408-5	70782-30-5127
Stud - Stuffing Box	370H	2	304 SS	21855-02-04	27177-715-2228
Impeller O-Ring	412A	1	Teflon	18461-15-38	C02495A286359
Maintenance Kit	902	1	Various	K-3196M-13	R196-MKM13
Repair Kit	906A	1	Various	RK-3196M	R196MTPRKO

Items in bold may or may not be in stock. Longer lead times may be required. RTF.

Griswold Pump Company - 107 Plantation Oak Drive - Thomasville, Georgia 31792
 Phone (229) 226-5255 - (800) 843-9222 Fax (229) 226-5567 - (800) 752-2929

**4 X 3 X 13 Liquid End Parts
 Model 811 - Medium Frame - (Replaces 3196 MT / MTX)**

Part	Item #	Qty Req.	Material	Griswold Part #	Goulds Part #
Case	100	1	DI	21289-01-N6	249-59-1012
			316SS	21289-01-91	249-65-1203
			CD4MCu	21289-01-X4	249-65-1216
			Alloy 20	21289-01-20	249-65-1204
Impeller	101	1	DI	21282-90-N6	0B10541-1013
			316SS	21282-90-91	0B10542-1203
			CD4MCu	21282-90-X4	0B10542-1216
			Alloy 20	21282-90-20	0B10542-1204
Lantern Ring	105	1	Teflon	21275	R76293
Packing	106	1	Kevlar	21647-16-4	A01081A06
Plain Gland	107	1	316 SS	21277-0-91	RB01050A-1203
Adapter	108	1	DI	24291-01-N6	262-94-1013
Stuffing Box - Standard Bore	184	1	DI	21290-01-N6	R100-530-1012
			316SS	21290-01-91	R100-529-1203
			CD4MCu	21290-01-X4	R100-529-1216
			Alloy 20	21290-01-20	R100-529-1204
Stuffing Box - Taper Bore	184	1	DI	24290-02-N6	RC04049A-1012
			316SS	24290-02-91	RC04111A01-1203
			CD4MCu	24290-02-X4	RC04111A01-1216
			Alloy 20	24290-02-20	RC04111A01-1204
Flush Gland	250	1	Various	Various	Various
Case Gasket (15% Glass-Filled TFE) (FDA Approved)	351	1	EPDM	10399-49-03	70782-28-5127
			Teflon	10399-49-05	70782-28-5117
			Gylon	10399-49-06	70782-28-5118
Gland Stud	353	2	316 SS	21855-02-04	27177-607-2229
Gland Stud Nut	355	2	304 SS	3932-62	495077-2228
Capscrew Frame - Case	370	16	Steel	3861-36	49511-252-2210
Hex Bolts - Jacking	418	3	Steel	3861-22	49521-204-2228
Hex Nut - Stuffing Box Stud	357K	2	304 SS	3932-82	495073-2228
Gasket, Frame To Adapter	360D	1	VELLUMOID	24400	73078-5130-0001
Gland Gasket-STD Box	360Q	1	EDPM	18408-5	70782-30-5127
Stud - Stuffing Box	370H	2	304 SS	21855-02-04	27177-715-2228
Impeller O-Ring	412A	1	Teflon	18461-15-38	C02495A286359
Maintenance Kit	902	1	Various	K-3196M-13	R196-MKM13
Repair Kit	906A	1	Various	RK-3196M	R196MTPRKO

Items in bold may or may not be in stock. Longer lead times may be required. RTF.

**6 X 4 X 13 Liquid End Parts
 Model 811 - Medium Frame - (Replaces 3196 MT / MTX)**

Part	Item #	Qty Req.	Material	Griswold Part #	Goulds Part #
Case	100	1	DI	21431-01-N6	D04928A-1012
			316SS	21431-01-91	D04930A-1203
			CD4MCu	21431-01-X4	D04930A-1216
			Alloy 20	21431-01-20	D04930A-1204
Impeller	101	1	DI	21421-90-N6	0101-499-1013
			316SS	21421-90-91	0101-500-1203
			CD4MCu	21421-90-X4	0101-500-1216
			Alloy 20	21421-90-20	0101-500-1204
Lantern Ring	105	1	Teflon	21275	R76293
Packing	106	1	Kevlar	21647-16-4	A01081A06
Plain Gland	107	1	316 SS	21277-0-91	RB01050A-1203
Adapter	108	1	DI	24291-01-N6	262-94-1013
Stuffing Box - Standard Bore	184	1	DI	21290-01-N6	R100-530-1012
			316SS	21290-01-91	R100-529-1203
			CD4MCu	21290-01-X4	R100-529-1216
			Alloy 20	21290-01-20	R100-529-1204
Stuffing Box - Taper Bore	184	1	DI	24290-02-N6	RC04049A-1012
			316SS	24290-02-91	RC04111A01-1203
			CD4MCu	24290-02-X4	RC04111A01-1216
			Alloy 20	24290-02-20	RC04111A01-1204
Flush Gland	250	1	Various	Various	Various
Case Gasket (15% Glass-Filled TFE) (FDA Approved)	351	1	EPDM	10399-49-03	70782-28-5127
			Teflon	10399-49-05	70782-28-5117
			Gylon	10399-49-06	70782-28-5118
Gland Stud	353	2	316 SS	21855-02-04	27177-607-2229
Gland Stud Nut	355	2	304 SS	3932-62	495077-2228
Capscrew Frame - Case	370	16	Steel	3861-36	49511-252-2210
Hex Bolts - Jacking	418	3	Steel	3861-22	49521-204-2228
Hex Nut - Stuffing Box Stud	357K	2	304 SS	3932-82	495073-2228
Gasket, Frame To Adapter	360D	1	VELLUMOID	24400	73078-5130-0001
Gland Gasket-STD Box	360Q	1	EDPM	18408-5	70782-30-5127
Stud - Stuffing Box	370H	2	304 SS	21855-02-04	27177-715-2228
Impeller O-Ring	412A	1	Teflon	18461-15-38	C02495A286359
Maintenance Kit	902	1	Various	K-3196M-13	R196-MKM13
Repair Kit	906A	1	Various	RK-3196M	R196MTPRKO

Items in bold may or may not be in stock. Longer lead times may be required. RTF.

Griswold Pump Company - 107 Plantation Oak Drive - Thomasville, Georgia 31792
 Phone (229) 226-5255 - (800) 843-9222 Fax (229) 226-5567 - (800) 752-2929

**2 X 1 X 10 Liquid End Parts
 Model 811 - Large Frame - (Replaces 3196 LT / LTX)**

Part	Item #	Qty Req.	Material	Griswold Part #	Goulds Part #
Case	100	1	DI	21334-01-N6	104-445-1012
			316SS	21334-01-91	104-878-1203
			CD4MCu	21334-01-X4	104-878-1216
			Alloy 20	21334-01-20	104-878-1204
Impeller	101	1	DI	L21329-60-N6	0104-14619-1013
			316SS	L21329-60-91	0104-14620-1203
			CD4MCu	L21329-60-X4	0104-14620-1216
			Alloy 20	L21329-60-20	0104-14620-1204
Lantern Ring	105	1	Teflon	21555	R76295
Packing	106	1	Kevlar	21647-21-4	A01081A07
Plain Gland	107	1	316 SS	21553-01-91	RC01298A-1203
Adapter	108	1	DI	24285-01-N6	262-93-1013
Stuffing Box - Standard Bore	184	1	DI	L21279-01-N6	R100-590-1012
			316SS	L21279-01-91	R100-589-1203
			CD4MCu	L21279-01-X4	R100-589-1216
			Alloy 20	L21279-01-20	R100-589-1204
Stuffing Box - Taper Bore	184	1	DI	L24279-02-N6	RC01382A33-1012
			316SS	L24279-02-91	RC01382A31-1203
			CD4MCu	L24279-02-x4	RC01382A31-1216
			Alloy 20	L24279-02-20	RC01382A31-1204
Flush Gland	250	1	Various	Various	Various
Case Gasket (15% Glass-Filled TFE) (FDA Approved)	351	1	EPDM	10399-50-03	70782-29-5127
			Teflon	10399-50-05	70782-29-5117
			Gylon	10399-50-06	70782-29-5118
Gland Stud	353	2	316 SS	21855-02-04	27177-607-2229
Gland Stud Nut	355	2	304 SS	3932-62	495077-2228
Capscrew Frame - Case	370	12	Steel	3861-36	49511-252-2210
Hex Bolts - Jacking	418	3	Steel	3861-22	49521-204-2228
Hex Nut - Stuffing Box Stud	357K	2	304 SS	3932-82	495073-2228
Gasket, Frame To Adapter	360D	1	VELLUMOID	24400	73078-5130-0001
Gland Gasket-STD Box	360Q	1	EDPM	18408-6	70782-24-5127
Stud - Stuffing Box	370H	2	304 SS	3862-84	27177-715-2228
Impeller O-Ring	412A	1	Teflon	18461-15-38	C02495A286359
Maintenance Kit	902	1	Various	K-3196L-10	R196-MKL10
Repair Kit	906A	1	Various	RK-3196L	R196LXPRKO

Items in bold may or may not be in stock. Longer lead times may be required. RTF.

Griswold Pump Company - 107 Plantation Oak Drive - Thomasville, Georgia 31792
 Phone (229) 226-5255 - (800) 843-9222 Fax (229) 226-5567 - (800) 752-2929

**3 X 1 1/2 X 10 Liquid End Parts
 Model 811 - Large Frame - (Replaces 3196 LT / LTX)**

Part	Item #	Qty Req.	Material	Griswold Part #	Goulds Part #
Case	100	1	DI	21271-01-N6	249-54-1012
			316SS	21271-01-91	249-60-1203
			CD4MCu	21271-01-X4	249-60-1216
			Alloy 20	21271-01-20	249-60-1204
Impeller	101	1	DI	L21272-60-N6	0104-14621-1013
			316SS	L21272-60-91	0104-14622-1203
			CD4MCu	L21272-60-X4	0104-14622-1216
			Alloy 20	L21272-60-20	0104-14622-1204
Lantern Ring	105	1	Teflon	21555	R76295
Packing	106	1	Kevlar	21647-21-4	A01081A07
Plain Gland	107	1	316 SS	21553-01-91	RC01298A-1203
Adapter	108	1	DI	24285-01-N6	262-93-1013
Stuffing Box - Standard Bore	184	1	DI	L21279-01-N6	R100-590-1012
			316SS	L21279-01-91	R100-589-1203
			CD4MCu	L21279-01-X4	R100-589-1216
			Alloy 20	L21279-01-20	R100-589-1204
Stuffing Box - Taper Bore	184	1	DI	L24279-02-N6	RCO1382A33-1012
			316SS	L24279-02-91	RCO1382A31-1203
			CD4MCu	L24279-02-X4	RCO1382A31-1216
			Alloy 20	L24279-02-20	RCO1382A31-1204
Flush Gland	250	1	Various	Various	Various
Case Gasket (15% Glass-Filled TFE) (FDA Approved)	351	1	EPDM	10399-50-03	70782-29-5127
			Teflon	10399-50-05	70782-29-5117
			Gylon	10399-50-06	70782-29-5118
Gland Stud	353	2	316 SS	21855-02-04	27177-607-2229
Gland Stud Nut	355	2	304 SS	3932-62	495077-2228
Capscrew Frame - Case	370	12	Steel	3861-36	49511-252-2210
Hex Bolts - Jacking	418	3	Steel	3861-22	49521-204-2228
Hex Nut - Stuffing Box Stud	357K	2	304 SS	3932-82	495073-2228
Gasket, Frame To Adapter	360D	1	VELLUMOID	24400	73078-5130-0001
Gland Gasket-STD Box	360Q	1	EDPM	18408-6	70782-24-5127
Stud - Stuffing Box	370H	2	304 SS	3862-84	27177-715-2228
Impeller O-Ring	412A	1	Teflon	18461-15-38	C02495A286359
Maintenance Kit	902	1	Various	K-3196L-10	R196-MKL10
Repair Kit	906A	1	Various	RK-3196L	R196LXPRKO

Items in bold may or may not be in stock. Longer lead times may be required. RTF.

Griswold Pump Company - 107 Plantation Oak Drive - Thomasville, Georgia 31792
 Phone (229) 226-5255 - (800) 843-9222 Fax (229) 226-5567 - (800) 752-2929

**3 X 2 X 10 Liquid End Parts
 Model 811 - Large Frame - (Replaces 3196 LT / LTX)**

Part	Item #	Qty Req.	Material	Griswold Part #	Goulds Part #
Case	100	1	DI	21327-01-N6	249-55-1012
			316SS	21327-01-91	249-61-1203
			CD4MCu	21327-01-X4	249-61-1216
			Alloy 20	21327-01-20	249-61-1204
Impeller	101	1	DI	L21422-60-N6	0104-14615-1013
			316SS	L21422-60-91	0104-14616-1203
			CD4MCu	L21422-60-X4	0104-14616-1216
			Alloy 20	L21422-60-20	0104-14616-1204
Lantern Ring	105	1	Teflon	21555	R76295
Packing	106	1	Kevlar	21647-21-4	A01081A07
Plain Gland	107	1	316 SS	21553-01-91	RC01298A-1203
Adapter	108	1	DI	24285-01-N6	262-93-1013
Stuffing Box - Standard Bore	184	1	DI	L21279-01-N6	R100-590-1012
			316SS	L21279-01-91	R100-589-1203
			CD4MCu	L21279-01-X4	R100-589-1216
			Alloy 20	L21279-01-20	R100-589-1204
Stuffing Box - Taper Bore	184	1	DI	L24279-02-N6	RCO1382A33-1012
			316SS	L24279-02-91	RCO1382A31-1203
			CD4MCu	L24279-02-X4	RCO1382A31-1216
			Alloy 20	L24279-02-20	RCO1382A31-1204
Flush Gland	250	1	Various	Various	Various
Case Gasket (15% Glass-Filled TFE) (FDA Approved)	351	1	EPDM	10399-50-03	70782-29-5127
			Teflon	10399-50-05	70782-29-5117
			Gylon	10399-50-06	70782-29-5118
Gland Stud	353	2	316 SS	21855-02-04	27177-607-2229
Gland Stud Nut	355	2	304 SS	3932-62	495077-2228
Capscrew Frame - Case	370	12	Steel	3861-36	49511-252-2210
Hex Bolts - Jacking	418	3	Steel	3861-22	49521-204-2228
Hex Nut - Stuffing Box Stud	357K	2	304 SS	3932-82	495073-2228
Gasket, Frame To Adapter	360D	1	VELLUMOID	24400	73078-5130-0001
Gland Gasket-STD Box	360Q	1	EDPM	18408-6	70782-24-5127
Stud - Stuffing Box	370H	2	304 SS	3862-84	27177-715-2228
Impeller O-Ring	412A	1	Teflon	18461-15-38	C02495A286359
Maintenance Kit	902	1	Various	K-3196L-10	R196-MKL10
Repair Kit	906A	1	Various	RK-3196L	R196LXPRKO

Items in bold may or may not be in stock. Longer lead times may be required. RTF.

Griswold Pump Company - 107 Plantation Oak Drive - Thomasville, Georgia 31792
 Phone (229) 226-5255 - (800) 843-9222 Fax (229) 226-5567 - (800) 752-2929

**4 X 3 X 10 Liquid End Parts
 Model 811 - Large Frame - (Replaces 3196 LT / LTX)**

Part	Item #	Qty Req.	Material	Griswold Part #	Goulds Part #
Case	100	1	DI	21274-01-N6	249-56-1012
			316SS	21274-01-91	249-62-1203
			CD4MCu	21274-01-X4	249-62-1216
			Alloy 20	21274-01-20	249-62-1204
Impeller	101	1	DI	L21273-60-N6	0104-14624-1013
			316SS	L21273-60-91	0104-14625-1203
			CD4MCu	L21273-60-X4	0104-14625-1216
			Alloy 20	L21273-60-20	0104-14625-1204
Lantern Ring	105	1	Teflon	21555	R76295
Packing	106	1	Kevlar	21647-21-4	A01081A07
Plain Gland	107	1	316 SS	21553-01-91	RC01298A-1203
Adapter	108	1	DI	24285-01-N6	262-93-1013
Stuffing Box - Standard Bore	184	1	DI	L21279-01-N6	R100-590-1012
			316SS	L21279-01-91	R100-589-1203
			CD4MCu	L21279-01-X4	R100-589-1216
			Alloy 20	L21279-01-20	R100-589-1204
Stuffing Box - Taper Bore	184	1	DI	L24279-02-N6	RC01382A33-1012
			316SS	L24279-02-91	RC01382A31-1203
			CD4MCu	L24279-02-X4	RC01382A31-1216
			Alloy 20	L24279-02-20	RC01382A31-1204
Flush Gland	250	1	Various	Various	Various
Case Gasket (15% Glass-Filled TFE) (FDA Approved)	351	1	EPDM	10399-50-03	70782-29-5127
			Teflon	10399-50-05	70782-29-5117
			Gylon	10399-50-06	70782-29-5118
Gland Stud	353	2	316 SS	21855-02-04	27177-607-2229
Gland Stud Nut	355	2	304 SS	3932-62	495077-2228
Capscrew Frame - Case	370	12	Steel	3861-36	49511-252-2210
Hex Bolts - Jacking	418	3	Steel	3861-22	49521-204-2228
Hex Nut - Stuffing Box Stud	357K	2	304 SS	3932-82	495073-2228
Gasket, Frame To Adapter	360D	1	VELLUMOID	24400	73078-5130-0001
Gland Gasket-STD Box	360Q	1	EDPM	18408-6	70782-24-5127
Stud - Stuffing Box	370H	2	304 SS	3862-84	27177-715-2228
Impeller O-Ring	412A	1	Teflon	18461-15-38	C02495A286359
Maintenance Kit	902	1	Various	K-3196L-10	R196-MKL10
Repair Kit	906A	1	Various	RK-3196L	R196LXPRKO

Items in bold may or may not be in stock. Longer lead times may be required. RTF.

**4 X 3 X 10H Liquid End Parts
 Model 811 - Large Frame - (Replaces 3196 LT / LTX)**

Part	Item #	Qty Req.	Material	Griswold Part #	Goulds Part #
Case	100	1	DI	21006-01-N6	D00452A01-1012
			316SS	21006-01-91	D00452A02-1203
			CD4MCu	21006-01-X4	D00452A02-1216
			Alloy 20	21006-01-20	D00452A02-1204
Impeller	101	1	DI	L21275-60-N6	0104-14627-1013
			316SS	L21275-60-91	0104-14628-1203
			CD4MCu	L21275-60-X4	0104-14628-1216
			Alloy 20	L21275-60-20	0104-14628-1204
Lantern Ring	105	1	Teflon	21555	R76295
Packing	106	1	Kevlar	21647-21-4	A01081A07
Plain Gland	107	1	316 SS	21553-01-91	RC01298A-1203
Adapter	108	1	DI	24285-01-N6	262-93-1013
Stuffing Box - Standard Bore	184	1	DI	L21279-01-N6	R100-590-1012
			316SS	L21279-01-91	R100-589-1203
			CD4MCu	L21279-01-X4	R100-589-1216
			Alloy 20	L21279-01-20	R100-589-1204
Stuffing Box - Taper Bore	184	1	DI	L24279-02-N6	RCO1382A33-1012
			316SS	L24279-02-91	RCO1382A31-1203
			CD4MCu	L24279-02-X4	RCO1382A31-1216
			Alloy 20	L24279-02-20	RCO1382A31-1204
Flush Gland	250	1	Various	Various	Various
Case Gasket (15% Glass-Filled TFE) (FDA Approved)	351	1	EPDM	10399-50-03	70782-29-5127
			Teflon	10399-50-05	70782-29-5117
			Gylon	10399-50-06	70782-29-5118
Gland Stud	353	2	316 SS	21855-02-04	27177-607-2229
Gland Stud Nut	355	2	304 SS	3932-62	495077-2228
Capscrew Frame - Case	370	12	Steel	3861-36	49511-252-2210
Hex Bolts - Jacking	418	3	Steel	3861-22	49521-204-2228
Hex Nut - Stuffing Box Stud	357K	2	304 SS	3932-82	495073-2228
Gasket, Frame To Adapter	360D	1	VELLUMOID	24400	73078-5130-0001
Gland Gasket-STD Box	360Q	1	EDPM	18408-6	70782-24-5127
Stud - Stuffing Box	370H	2	304 SS	3862-84	27177-715-2228
Impeller O-Ring	412A	1	Teflon	18461-15-38	C02495A286359
Maintenance Kit	902	1	Various	K-3196L-10	R196-MKL10
Repair Kit	906A	1	Various	RK-3196L	R196LXPRKO

Items in bold may or may not be in stock. Longer lead times may be required. RTF.

Griswold Pump Company - 107 Plantation Oak Drive - Thomasville, Georgia 31792
 Phone (229) 226-5255 - (800) 843-9222 Fax (229) 226-5567 - (800) 752-2929

**6 X 4 X 10 Liquid End Parts
 Model 811 - Large Frame - (Replaces 3196 LT / LTX)**

Part	Item #	Qty Req.	Material	Griswold Part #	Goulds Part #
Case	100	1	DI	21007-01-N6	251-91-1012
			316SS	21007-01-91	251-89-1203
			CD4MCu	21007-01-X4	251-89-1216
			Alloy 20	21007-01-20	251-89-1204
Impeller	101	1	DI	L21373-60-N6	0104-14617-1013
			316SS	L21373-60-91	0104-14618-1203
			CD4MCu	L21373-60-X4	0104-14618-1216
			Alloy 20	L21373-60-20	0104-14618-1204
Lantern Ring	105	1	Teflon	21555	R76295
Packing	106	1	Kevlar	21647-21-4	A01081A07
Plain Gland	107	1	316 SS	21553-01-91	RC01298A-1203
Adapter	108	1	DI	24285-01-N6	262-93-1013
Stuffing Box - Standard Bo	184	1	DI	L21279-01-N6	R100-590-1012
			316SS	L21279-01-91	R100-589-1203
			CD4MCu	L21279-01-X4	R100-589-1216
			Alloy 20	L21279-01-20	R100-589-1204
Stuffing Box - Taper Bore	184	1	DI	L24279-02-N6	RC01382A33-1012
			316SS	L24279-02-91	RC01382A31-1203
			CD4MCu	L24279-02-X4	RC01382A31-1216
			Alloy 20	L24279-02-20	RC01382A31-1204
Flush Gland	250	1	Various	Various	Various
Case Gasket (15% Glass-Filled TFE) (FDA Approved)	351	1	EPDM	10399-50-03	70782-29-5127
			Teflon	10399-50-05	70782-29-5117
			Gylon	10399-50-06	70782-29-5118
Gland Stud	353	2	316 SS	21855-02-04	27177-607-2229
Gland Stud Nut	355	2	304 SS	3932-62	495077-2228
Capscrew Frame - Case	370	12	Steel	3861-36	49511-252-2210
Hex Bolts - Jacking	418	3	Steel	3861-22	49521-204-2228
Hex Nut - Stuffing Box Stud	357K	2	304 SS	3932-82	495073-2228
Gasket, Frame To Adapter	360D	1	VELLUMOID	24400	73078-5130-0001
Gland Gasket-STD Box	360Q	1	EDPM	18408-6	70782-24-5127
Stud - Stuffing Box	370H	2	304 SS	3862-84	27177-715-2228
Impeller O-Ring	412A	1	Teflon	18461-15-38	C02495A286359
Maintenance Kit	902	1	Various	K-3196L-10	R196-MKL10
Repair Kit	906A	1	Various	RK-3196L	R196LXPRKO

Items in bold may or may not be in stock. Longer lead times may be required. RTF.

**6 X 4 X 10 G Liquid End Parts
 Model 811 - Large Frame - (Replaces 3196 LT / LTX)**

Part	Item #	Qty Req.	Material	Griswold Part #	Goulds Part #
Case	100	1	DI	21008-01-N6	D08740A-1012
			316SS	21008-01-91	D08742A-1203
			CD4MCu	21008-01-X4	D08742A-1216
			Alloy 20	21008-01-20	D08742A-1204
Impeller	101	1	DI	L21374-60-N6	C06088A-1013
			316SS	L21374-60-91	C06089A-1203
			CD4MCu	L21374-60-X4	C06089A-1216
			Alloy 20	L21374-60-20	C06089A-1204
Lantern Ring	105	1	Teflon	21555	R76295
Packing	106	1	Kevlar	21647-21-4	A01081A07
Plain Gland	107	1	316 SS	21553-01-91	RC01298A-1203
Adapter	108	1	DI	24285-01-N6	262-93-1013
Stuffing Box - Standard Bo	184	1	DI	L21279-01-N6	R100-590-1012
			316SS	L21279-01-91	R100-589-1203
			CD4MCu	L21279-01-X4	R100-589-1216
			Alloy 20	L21279-01-20	R100-589-1204
Stuffing Box - Taper Bore	184	1	DI	L24279-02-N6	RCO1382A33-1012
			316SS	L24279-02-91	RCO1382A31-1203
			CD4MCu	L24279-02-X4	RCO1382A31-1216
			Alloy 20	L24279-02-20	RCO1382A31-1204
Flush Gland	250	1	Various	Various	Various
Case Gasket (15% Glass-Filled TFE) (FDA Approved)	351	1	EPDM	10399-50-03	70782-29-5127
			Teflon	10399-50-05	70782-29-5117
			Gylon	10399-50-06	70782-29-5118
Gland Stud	353	2	316 SS	21855-02-04	27177-607-2229
Gland Stud Nut	355	2	304 SS	3932-62	495077-2228
Capscrew Frame - Case	370	12	Steel	3861-36	49511-252-2210
Hex Bolts - Jacking	418	3	Steel	3861-22	49521-204-2228
Hex Nut - Stuffing Box Stud	357K	2	304 SS	3932-82	495073-2228
Gasket, Frame To Adapter	360D	1	VELLUMOID	24400	73078-5130-0001
Gland Gasket-STD Box	360Q	1	EDPM	18408-6	70782-24-5127
Stud - Stuffing Box	370H	2	304 SS	3862-84	27177-715-2228
Impeller O-Ring	412A	1	Teflon	18461-15-38	C02495A286359
Maintenance Kit	902	1	Various	K-3196L-10	R196-MKL10
Repair Kit	906A	1	Various	RK-3196L	R196LXPRKO

Items in bold may or may not be in stock. Longer lead times may be required. RTF.

**6 X 4 X 10 H Liquid End Parts
 Model 811 - Large Frame - (Replaces 3196 LT / LTX)**

Part	Item #	Qty Req.	Material	Griswold Part #	Goulds Part #
Case	100	1	DI	21009-01-N6	D03194A-1012
			316SS	21009-01-91	D03123A-1203
			CD4MCu	21009-01-X4	D03123A-1216
			Alloy 20	21009-01-20	D03123A-1204
Impeller	101	1	DI	L21375-60-N6	0104-14633-1013
			316SS	L21375-60-91	0104-14634-1203
			CD4MCu	L21375-60-X4	0104-14634-1216
			Alloy 20	L21375-60-20	0104-14634-1204
Lantern Ring	105	1	Teflon	21555	R76295
Packing	106	1	Kevlar	21647-21-4	A01081A07
Plain Gland	107	1	316 SS	21553-01-91	RC01298A-1203
Adapter	108	1	DI	24285-01-N6	262-93-1013
Stuffing Box - Standard Bore	184	1	DI	L21279-01-N6	R100-590-1012
			316SS	L21279-01-91	R100-589-1203
			CD4MCu	L21279-01-X4	R100-589-1216
			Alloy 20	L21279-01-20	R100-589-1204
Stuffing Box - Taper Bore	184	1	DI	L24279-02-N6	RC01382A33-1012
			316SS	L24279-02-91	RC01382A31-1203
			CD4MCu	L24279-02-X4	RC01382A31-1216
			Alloy 20	L24279-02-20	RC01382A31-1204
Flush Gland	250	1	Various	Various	Various
Case Gasket (15% Glass-Filled TFE) (FDA Approved)	351	1	EPDM	10399-50-03	70782-29-5127
			Teflon	10399-50-05	70782-29-5117
			Gylon	10399-50-06	70782-29-5118
Gland Stud	353	2	316 SS	21855-02-04	27177-607-2229
Gland Stud Nut	355	2	304 SS	3932-62	495077-2228
Capscrew Frame - Case	370	12	Steel	3861-36	49511-252-2210
Hex Bolts - Jacking	418	3	Steel	3861-22	49521-204-2228
Hex Nut - Stuffing Box Stud	357K	2	304 SS	3932-82	495073-2228
Gasket, Frame To Adapter	360D	1	VELLUMOID	24400	73078-5130-0001
Gland Gasket-STD Box	360Q	1	EDPM	18408-6	70782-24-5127
Stud - Stuffing Box	370H	2	304 SS	3862-84	27177-715-2228
Impeller O-Ring	412A	1	Teflon	18461-15-38	C02495A286359
Maintenance Kit	902	1	Various	K-3196L-10	R196-MKL10
Repair Kit	906A	1	Various	RK-3196L	R196LXPRKO

Items in bold may or may not be in stock. Longer lead times may be required. RTF.

**3 X 1 1/2 X 13 Liquid End Parts
 Model 811 - Large Frame - (Replaces 3196 LT / LTX)**

Part	Item #	Qty Req.	Material	Griswold Part #	Goulds Part #
Case	100	1	DI	21295-01-N6	249-57-1012
			316SS	21295-01-91	249-63-1203
			CD4MCu	21295-01-X4	249-63-1216
			Alloy 20	21295-01-20	249-63-1204
Impeller	101	1	DI	L21283-60-N6	0104-146-1-1013
			316SS	L21283-60-91	0104-146-2-1203
			CD4MCu	L21283-60-X4	0104-146-2-1216
			Alloy 20	L21283-60-20	0104-146-2-1204
Lantern Ring	105	1	Teflon	21555	R76295
Packing	106	1	Kevlar	21647-21-4	A01081A07
Plain Gland	107	1	316 SS	21553-01-91	RC01298A-1203
Adapter	108	1	DI	24291-01-N6	262-94-1013
Stuffing Box - Standard Bore	184	1	DI	L21290-01-N6	R100-534-1012
			316SS	L21290-01-91	R100-533-1203
			CD4MCu	L21290-01-X4	R100-533-1216
			Alloy 20	L21290-01-20	R100-533-1204
Stuffing Box - Taper Bore	184	1	DI	L24290-02-N6	RC01382A39-1012
			316SS	L24290-02-91	RC01382A37-1203
			CD4MCu	L24290-02-X4	RC01382A37-1216
			Alloy 20	L24290-02-20	RC01382A37-1204
Flush Gland	250	1	Various	Various	Various
Case Gasket (15% Glass-Filled TFE) (FDA Approved)	351	1	EPDM	10399-49-03	70782-29-5127
			Teflon	10399-49-05	70782-29-5117
			Gylon	10399-49-06	70782-29-5118
Gland Stud	353	2	316 SS	21855-02-04	27177-607-2229
Gland Stud Nut	355	2	304 SS	3932-62	495077-2228
Capscrew Frame - Case	370	16	Steel	3861-36	49511-252-2210
Hex Bolts - Jacking	418	3	Steel	3861-22	49521-204-2228
Hex Nut - Stuffing Box Stud	357K	2	304 SS	3932-82	495073-2228
Gasket, Frame To Adapter	360D	1	VELLUMOID	24400	73078-5130-0001
Gland Gasket-STD Box	360Q	1	EDPM	18408-6	70782-24-5127
Stud - Stuffing Box	370H	2	304 SS	3862-84	27177-715-2228
Impeller O-Ring	412A	1	Teflon	18461-15-38	C02495A286359
Maintenance Kit	902	1	Various	K-3196L-13	R196-MKL13
Repair Kit	906A	1	Various	RK-3196L	R196LXPRKO

Items in bold may or may not be in stock. Longer lead times may be required. RTF.

Griswold Pump Company - 107 Plantation Oak Drive - Thomasville, Georgia 31792
 Phone (229) 226-5255 - (800) 843-9222 Fax (229) 226-5567 - (800) 752-2929

**3 X 2 X 13 Liquid End Parts
 Model 811 - Large Frame - (Replaces 3196 LT / LTX)**

Part	Item #	Qty Req.	Material	Griswold Part #	Goulds Part #
Case	100	1	DI	21296-01-N6	D02451A-1012
			316SS	21296-01-91	D02450A-1203
			CD4MCu	21296-01-X4	D02450A-1216
			Alloy 20	21296-01-20	D02450A-1204
Impeller	101	1	DI	L21423-90-N6	0B10589-1013
			316SS	L21423-90-91	0B10588-1203
			CD4MCu	L21423-90-X4	0B10588-1216
			Alloy 20	L21423-90-20	0B10588-1204
Lantern Ring	105	1	Teflon	21555	R76295
Packing	106	1	Kevlar	21647-21-4	A01081A07
Plain Gland	107	1	316 SS	21553-01-91	RC01298A-1203
Adapter	108	1	DI	24291-01-N6	262-94-1013
Stuffing Box - Standard Bore	184	1	DI	L21290-01-N6	R100-534-1012
			316SS	L21290-01-91	R100-533-1203
			CD4MCu	L21290-01-X4	R100-533-1216
			Alloy 20	L21290-01-20	R100-533-1204
Stuffing Box - Taper Bore	184	1	DI	L24290-02-N6	RC01382A39-1012
			316SS	L24290-02-91	RC01382A37-1203
			CD4MCu	L24290-02-X4	RC01382A37-1216
			Alloy 20	L24290-02-20	RC01382A37-1204
Flush Gland	250	1	Various	Various	Various
Case Gasket (15% Glass-Filled TFE) (FDA Approved)	351	1	EPDM	10399-49-03	70782-28-5127
			Teflon	10399-49-05	70782-28-5117
			Gylon	10399-49-06	70782-28-5118
Gland Stud	353	2	316 SS	21855-02-04	27177-607-2229
Gland Stud Nut	355	2	304 SS	3932-62	495077-2228
Capscrew Frame - Case	370	16	Steel	3861-36	49511-252-2210
Hex Bolts - Jacking	418	3	Steel	3861-22	49521-204-2228
Hex Nut - Stuffing Box Stud	357K	2	304 SS	3932-82	495073-2228
Gasket, Frame To Adapter	360D	1	VELLUMOIL	24400	73078-5130-0001
Gland Gasket-STD Box	360Q	1	EDPM	18408-6	70782-24-5127
Stud - Stuffing Box	370H	2	304 SS	3862-84	27177-715-2228
Impeller O-Ring	412A	1	Teflon	18461-15-38	C02495A286359
Maintenance Kit	902	1	Various	K-3196L-13	R196-MKL13
Repair Kit	906A	1	Various	RK-3196L	R196LXPRKO

Items in bold may or may not be in stock. Longer lead times may be required. RTF.

**4 X 3 X 13 Liquid End Parts
 Model 811 - Large Frame - (Replaces 3196 LT / LTX)**

Part	Item #	Qty Req.	Material	Griswold Part #	Goulds Part #
Case	100	1	DI	21289-01-N6	249-59-1012
			316SS	21289-01-91	249-65-1203
			CD4MCu	21289-01-X4	249-65-1216
			Alloy 20	21289-01-20	249-65-1204
Impeller	101	1	DI	L21282-90-N6	OB10591-1013
			316SS	L21282-90-91	OB10592-1203
			CD4MCu	L21282-90-X4	OB10592-1216
			Alloy 20	L21282-90-20	OB10592-1204
Lantern Ring	105	1	Teflon	21555	R76295
Packing	106	1	Kevlar	21647-21-4	A01081A07
Plain Gland	107	1	316 SS	21553-01-91	RC01298A-1203
Adapter	108	1	DI	24291-01-N6	262-94-1013
Stuffing Box - Standard Bore	184	1	DI	L21290-01-N6	R100-534-1012
			316SS	L21290-01-91	R100-533-1203
			CD4MCu	L21290-01-X4	R100-533-1216
			Alloy 20	L21290-01-20	R100-533-1204
Stuffing Box - Taper Bore	184	1	DI	L24290-02-N6	RC01382A39-1012
			316SS	L24290-02-91	RC01382A37-1203
			CD4MCu	L24290-02-X4	RC01382A37-1216
			Alloy 20	L24290-02-20	RC01382A37-1204
Flush Gland	250	1	Various	Various	Various
Case Gasket (15% Glass-Filled TFE) (FDA Approved)	351	1	EPDM	10399-49-03	70782-28-5127
			Teflon	10399-49-05	70782-28-5117
			Gylon	10399-49-06	70782-28-5118
Gland Stud	353	2	316 SS	21855-02-04	27177-607-2229
Gland Stud Nut	355	2	304 SS	3932-62	495077-2228
Capscrew Frame - Case	370	16	Steel	3861-36	49511-252-2210
Hex Bolts - Jacking	418	3	Steel	3861-22	49521-204-2228
Hex Nut - Stuffing Box Stud	357K	2	304 SS	3932-82	495073-2228
Gasket, Frame To Adapter	360D	1	VELLUMOID	24400	73078-5130-0001
Gland Gasket-STD Box	360Q	1	EDPM	18408-6	70782-24-5127
Stud - Stuffing Box	370H	2	304 SS	3862-84	27177-715-2228
Impeller O-Ring	412A	1	Teflon	18461-15-38	C02495A286359
Maintenance Kit	902	1	Various	K-3196L-13	R196-MKL13
Repair Kit	906A	1	Various	RK-3196L	R196LXPRKO

Items in bold may or may not be in stock. Longer lead times may be required. RTF.

**6 X 4 X 13 Liquid End Parts
 Model 811 - Large Frame - (Replaces 3196 LT / LTX)**

Part	Item #	Qty Req.	Material	Griswold Part #	Goulds Part #
Case	100	1	DI	21431-01-N6	D04928A-1012
			316SS	21431-01-91	D04930A-1203
			CD4MCu	21431-01-X4	D04930A-1216
			Alloy 20	21431-01-20	D04930A-1204
Impeller	101	1	DI	L21421-90-N6	0104-14610-1013
			316SS	L21421-90-91	0104-14611-1203
			CD4MCu	L21421-90-X4	0104-14611-1216
			Alloy 20	L21421-90-20	0104-14611-1204
Lantern Ring	105	1	Teflon	21555	R76295
Packing	106	1	Kevlar	21647-21-4	A01081A07
Plain Gland	107	1	316 SS	21553-01-91	RC01298A-1203
Adapter	108	1	DI	24291-01-N6	262-94-1013
Stuffing Box - Standard Bore	184	1	DI	L21290-01-N6	R100-534-1012
			316SS	L21290-01-91	R100-533-1203
			CD4MCu	L21290-01-X4	R100-533-1216
			Alloy 20	L21290-01-20	R100-533-1204
Stuffing Box - Taper Bore	184	1	DI	L24290-02-N6	RC01382A39-1012
			316SS	L24290-02-91	RC01382A37-1203
			CD4MCu	L24290-02-X4	RC01382A37-1216
			Alloy 20	L24290-02-20	RC01382A37-1204
Flush Gland	250	1	Various	Various	Various
Case Gasket (15% Glass-Filled TFE) (FDA Approved)	351	1	EPDM	10399-49-03	70782-28-5127
			Teflon	10399-49-05	70782-28-5117
			Gylon	10399-49-06	70782-28-5118
Gland Stud	353	2	316 SS	21855-02-04	27177-607-2229
Gland Stud Nut	355	2	304 SS	3932-62	495077-2228
Capscrew Frame - Case	370	16	Steel	3861-36	49511-252-2210
Hex Bolts - Jacking	418	3	Steel	3861-22	49521-204-2228
Hex Nut - Stuffing Box Stud	357K	2	304 SS	3932-82	495073-2228
Gasket, Frame To Adapter	360D	1	VELLUMOID	24400	73078-5130-0001
Gland Gasket-STD Box	360Q	1	EDPM	18408-6	70782-24-5127
Stud - Stuffing Box	370H	2	304 SS	3862-84	27177-715-2228
Impeller O-Ring	412A	1	Teflon	18461-15-38	C02495A286359
Maintenance Kit	902	1	Various	K-3196L-13	R196-MKL13
Repair Kit	906A	1	Various	RK-3196L	R196LXPRKO

Items in bold may or may not be in stock. Longer lead times may be required. RTF.

Griswold Pump Company - 107 Plantation Oak Drive - Thomasville, Georgia 31792
 Phone (229) 226-5255 - (800) 843-9222 Fax (229) 226-5567 - (800) 752-2929

**6 X 8 X 15 Liquid End Parts
 Model 811 - Extra Large Frame - (Replaces 3196 XLTX)**

Part	Item #	Qty Req.	Material	Griswold Part #	Goulds Part #
Case	100	1	DI	24435-01-N6	254-93-1012
			316SS	24435-01-91	254-94-1203
			CD4MCu	24435-01-X4	254-94-1216
			Alloy 20	24435-01-20	254-94-1204
Impeller	101	1	DI	24439-01-N6	0256-115-1013
			316SS	24439-01-91	0256-116-1203
			CD4MCu	24439-01-X4	0256-116-1216
			Alloy 20	24439-01-20	0256-116-1204
Lantern Ring	105	1	Teflon	21600	R76298
Packing	106	1	Kevlar	21647-22-4	A01081A12
Plain Gland	107	1	316 SS	24017-01-91	RC03355A-1203
Adapter	108	1	DI	24446-01-N6	R102-814-1013
Stuffing Box - Standard B	184	1	DI	24443-01-N6	R104-709-1012
			316SS	24443-01-91	R104-710-1203
			CD4MCu	24443-01-X4	R104-710-1216
			Alloy 20	24443-01-20	R104-710-1204
Stuffing Box - Taper Bore	184	1	DI	24443-02-N6	RC01382A51-1012
			316SS	24443-02-91	RC01382A49-1203
			CD4MCu	24443-02-X4	RC01382A49-1216
			Alloy 20	24443-02-20	RC01382A49-1204
Flush Gland	250	1	Various	Various	Various
Case Gasket (15% Glass-Filled TFE) (FDA Approved)	351	1	EPDM	10399-68-03	70782-49-5127
			Teflon	10399-68-05	70782-49-5117
			Gylon	10399-68-06	70782-49-5118
Gland Stud	353	2	316 SS	21855-02-06	27177-439-2229
Gland Stud Nut	355	2	304 SS	3932-72	495077-2228
Capscrew Adp. - Case	370	24	Steel	3861-72	49511-253-2210
		24	304 SS	3861-74	49511-253-2228
Hex Bolts - Jacking	418	3	Steel	3861-22	49521-204-2228
Hex Nut - Stuffing Box St	357K	2	304 SS	3932-62	49507-57--2228
Impeller Pipe Plug & Was	358Y	1	DI/316SS	21001-01-91	A02827A04-2229
			CD4/Alloy20	21001-01-20	A02827A04-2230
Gasket, Frame To Adapte	360D	1	VELLUMOID	24400	73078-5130-0001
Gland Gasket	360Q	1	EDPM	RTF	RTF
Stud - Stuffing Box	370H	2	316 SS	21855-02-04	27177-626-2228
Impeller O-Ring	412A	1	Teflon	21003-01-OR	C02495A34-6359
Impeller Washer	428D	1	Teflon	21002-01-WS	A05105A01
Maintenance Kit	902	1	Various	K-3196XL-15	R196-MKX15
Repair Kit	906A	1	Various	RK-3196X	R196XLPRKO

Items in bold may or may not be in stock. Longer lead times may be required. RTF.

Griswold Pump Company - 107 Plantation Oak Drive - Thomasville, Georgia 31792
 Phone (229) 226-5255 - (800) 843-9222 Fax (229) 226-5567 - (800) 752-2929

**8 X 10 X 15 Liquid End Parts
 Model 811 - Extra Large Frame - (Replaces 3196 XLTX)**

Part	Item #	Qty Req.	Material	Griswold Part #	Goulds Part #
Case	100	1	DI	24436-01-N6	256-64-1012
			316SS	24436-01-91	256-65-1203
			CD4MCu	24436-01-X4	256-65-1216
			Alloy 20	24436-01-20	256-65-1204
Impeller	101	1	DI	24441-01-N6	0256-121-1013
			316SS	24441-01-91	0256-122-1203
			CD4MCu	24441-01-X4	0256-122-1216
			Alloy 20	24441-01-20	0256-122-1204
Lantern Ring	105	1	Teflon	21600	R76298
Packing	106	1	Kevlar	21647-22-4	A01081A12
Plain Gland	107	1	316 SS	24017-01-91	RC03355A-1203
Adapter	108	1	DI	24446-01-N6	R102-814-1013
Stuffing Box - Standard B	184	1	DI	24443-01-N6	R104-709-1012
			316SS	24443-01-91	R104-710-1203
			CD4MCu	24443-01-X4	R104-710-1216
			Alloy 20	24443-01-20	R104-710-1204
Stuffing Box - Taper Bore	184	1	DI	24443-02-N6	RC01382A51-1012
			316SS	24443-02-91	RC01382A49-1203
			CD4MCu	24443-02-X4	RC01382A49-1216
			Alloy 20	24443-02-20	RC01382A49-1204
Flush Gland	250	1	Various	Various	Various
Case Gasket (15% Glass-Filled TFE) (FDA Approved)	351	1	EPDM	10399-68-03	70782-49-5127
			Teflon	10399-68-05	70782-49-5117
			Gylon	10399-68-06	70782-49-5118
Gland Stud	353	2	316 SS	21855-02-06	27177-439-2229
Gland Stud Nut	355	2	304 SS	3932-72	495077-2228
Capscrew Adp. - Case	370	24	Steel	3861-72	49511-253-2210
		24	304 SS	3861-74	49511-253-2228
Hex Bolts - Jacking	418	3	Steel	3861-22	49521-204-2228
Hex Nut - Stuffing Box St	357K	2	304 SS	3932-62	49507-57--2228
Impeller Pipe Plug & Was	358Y	1	DI/316SS	21001-01-91	A02827A04-2229
			CD4/Alloy 20	21001-01-20	A02827A04-2230
Gasket, Frame To Adapte	360D	1	VELLUMOID	24400	73078-5130-0001
Gland Gasket	360Q	1	EDPM	RTF	RTF
Stud - Stuffing Box	370H	2	316 SS	21855-02-04	27177-626-2228
Impeller O-Ring	412A	1	Teflon	21003-01-OR	C02495A34-6359
Impeller Washer	428D	1	Teflon	21002-01-WS	A05105A01
Maintenance Kit	902	1	Various	K-3196XL-15	R196-MKX15
Repair Kit	906A	1	Various	RK-3196X	R196XLPRKO

Items in bold may or may not be in stock. Longer lead times may be required. RTF.

Griswold Pump Company - 107 Plantation Oak Drive - Thomasville, Georgia 31792
 Phone (229) 226-5255 - (800) 843-9222 Fax (229) 226-5567 - (800) 752-2929

Goolds Parts in Ascending Order

Part	Qty	Material	Griswold Part #	Goolds Part #	Model Used On	
Item #	Req.					
Impeller	101	1	316SS	23020-20-91	0100-155-1203	811M 3X2-6
Impeller	101	1	Alloy 20	23020-20-20	0100-155-1204	811M 3X2-6
Impeller	101	1	CD4MCu	23020-20-X4	0100-155-1216	811M 3X2-6
Impeller	101	1	DI	23020-20-N6	0100-156-1013	811M 3X2-6
Impeller	101	1	316SS	21328-43-91	0100-161-1203	811M 3X2-8
Impeller	101	1	Alloy 20	21328-43-20	0100-161-1204	811M 3X2-8
Impeller	101	1	CD4MCu	21328-43-X4	0100-161-1216	811M 3X2-8
Impeller	101	1	DI	21328-43-N6	0100-162-1013	811M 3X2-8
Impeller	101	1	316SS	21338-40-91	0100-163-1203	811M 4X3-8
Impeller	101	1	Alloy 20	21338-40-20	0100-163-1204	811M 4X3-8
Impeller	101	1	CD4MCu	21338-40-X4	0100-163-1216	811M 4X3-8
Impeller	101	1	DI	21338-40-N6	0100-164-1013	811M 4X3-8
Impeller	101	1	316SS	21337-40-91	0100-165-1203	811M 4X3-8G
Impeller	101	1	Alloy 20	21337-40-20	0100-165-1204	811M 4X3-8G
Impeller	101	1	CD4MCu	21337-40-X4	0100-165-1216	811M 4X3-8G
Impeller	101	1	DI	21337-40-N6	0100-166-1013	811M 4X3-8G
Impeller	101	1	316SS	21283-90-91	0100-537-1203	811M 3X1.5-13
Impeller	101	1	Alloy 20	21283-90-20	0100-537-1204	811M 3X1.5-13
Impeller	101	1	CD4MCu	21283-90-X4	0100-537-1216	811M 3X1.5-13
Impeller	101	1	DI	21283-90-N6	0100-538-1013	811M 3X1.5-13
Impeller	101	1	316SS	21423-90-91	0100-539-1203	811M 3X2-13
Impeller	101	1	Alloy 20	21423-90-20	0100-539-1204	811M 3X2-13
Impeller	101	1	CD4MCu	21423-90-X4	0100-539-1216	811M 3X2-13
Impeller	101	1	DI	21423-90-N6	0100-540-1013	811M 3X2-13
Impeller	101	1	316SS	21272-60-91	0100-593-1203	811M 3X1.5-10
Impeller	101	1	Alloy 20	21272-60-20	0100-593-1204	811M 3X1.5-10
Impeller	101	1	CD4MCu	21272-60-X4	0100-593-1216	811M 3X1.5-10
Impeller	101	1	DI	21272-60-N6	0100-594-1013	811M 3X1.5-10
Impeller	101	1	316SS	21422-60-91	0100-595-1203	811M 3X2-10
Impeller	101	1	Alloy 20	21422-60-20	0100-595-1204	811M 3X2-10
Impeller	101	1	CD4MCu	21422-60-X4	0100-595-1216	811M 3X2-10
Impeller	101	1	DI	21422-60-N6	0100-596-1013	811M 3X2-10
Impeller	101	1	316SS	21273-60-91	0100-597-1203	811M 4X3-10
Impeller	101	1	Alloy 20	21273-60-20	0100-597-1204	811M 4X3-10
Impeller	101	1	CD4MCu	21273-60-X4	0100-597-1216	811M 4X3-10
Impeller	101	1	DI	21273-60-N6	0100-598-1013	811M 4X3-10
Impeller	101	1	DI	21421-90-N6	0101-499-1013	811M 6X4-13
Impeller	101	1	316SS	21421-90-91	0101-500-1203	811M 6X4-13
Impeller	101	1	Alloy 20	21421-90-20	0101-500-1204	811M 6X4-13
Impeller	101	1	CD4MCu	21421-90-X4	0101-500-1216	811M 6X4-13
Impeller	101	1	DI	21373-60-N6	0101-527-1013	811M 6X4-10
Impeller	101	1	316SS	21373-60-91	0101-528-1203	811M 6X4-10
Impeller	101	1	Alloy 20	21373-60-20	0101-528-1204	811M 6X4-10
Impeller	101	1	CD4MCu	21373-60-X4	0101-528-1216	811M 6X4-10
Impeller	101	1	DI	L21421-90-N6	0104-14610-1013	811L 6X4-13
Impeller	101	1	DI	L21283-60-N6	0104-146-1-1013	811L 3X1.5-13
Impeller	101	1	316SS	L21421-90-91	0104-14611-1203	811L 6X4-13
Impeller	101	1	Alloy 20	L21421-90-20	0104-14611-1204	811L 6X4-13
Impeller	101	1	CD4MCu	L21421-90-X4	0104-14611-1216	811L 6X4-13
Impeller	101	1	DI	L21422-60-N6	0104-14615-1013	811L 3X2-10
Impeller	101	1	316SS	L21422-60-91	0104-14616-1203	811L 3X2-10
Impeller	101	1	Alloy 20	L21422-60-20	0104-14616-1204	811L 3X2-10
Impeller	101	1	CD4MCu	L21422-60-X4	0104-14616-1216	811L 3X2-10
Impeller	101	1	DI	L21373-60-N6	0104-14617-1013	811L 6X4-10
Impeller	101	1	316SS	L21373-60-91	0104-14618-1203	811L 6X4-10
Impeller	101	1	Alloy 20	L21373-60-20	0104-14618-1204	811L 6X4-10
Impeller	101	1	CD4MCu	L21373-60-X4	0104-14618-1216	811L 6X4-10
Impeller	101	1	DI	L21329-60-N6	0104-14619-1013	811L 2X1-10
Impeller	101	1	316SS	L21329-60-91	0104-14620-1203	811L 2X1-10
Impeller	101	1	Alloy 20	L21329-60-20	0104-14620-1204	811L 2X1-10
Impeller	101	1	CD4MCu	L21329-60-X4	0104-14620-1216	811L 2X1-10

Goolds Parts in Ascending Order

Part	Qty	Material	Griswold Part #	Goolds Part #	Model Used On	
Item #	Req.					
Impeller	101	1	DI	L21272-60-N6	0104-14621-1013	811L 3X1.5-10
Impeller	101	1	316SS	L21283-60-91	0104-146-2-1203	811L 3X1.5-13
Impeller	101	1	Alloy 20	L21283-60-20	0104-146-2-1204	811L 3X1.5-13
Impeller	101	1	CD4MCu	L21283-60-X4	0104-146-2-1216	811L 3X1.5-13
Impeller	101	1	316SS	L21272-60-91	0104-14622-1203	811L 3X1.5-10
Impeller	101	1	Alloy 20	L21272-60-20	0104-14622-1204	811L 3X1.5-10
Impeller	101	1	CD4MCu	L21272-60-X4	0104-14622-1216	811L 3X1.5-10
Impeller	101	1	DI	L21273-60-N6	0104-14624-1013	811L 4X3-10
Impeller	101	1	316SS	L21273-60-91	0104-14625-1203	811L 4X3-10
Impeller	101	1	Alloy 20	L21273-60-20	0104-14625-1204	811L 4X3-10
Impeller	101	1	CD4MCu	L21273-60-X4	0104-14625-1216	811L 4X3-10
Impeller	101	1	DI	L21275-60-N6	0104-14627-1013	811L 4X3-10H
Impeller	101	1	316SS	L21275-60-91	0104-14628-1203	811L 4X3-10H
Impeller	101	1	Alloy 20	L21275-60-20	0104-14628-1204	811L 4X3-10H
Impeller	101	1	CD4MCu	L21275-60-X4	0104-14628-1216	811L 4X3-10H
Impeller	101	1	DI	L21375-60-N6	0104-14633-1013	811L 6X4-10H
Impeller	101	1	316SS	L21375-60-91	0104-14634-1203	811L 6X4-10H
Impeller	101	1	Alloy 20	L21375-60-20	0104-14634-1204	811L 6X4-10H
Impeller	101	1	CD4MCu	L21375-60-X4	0104-14634-1216	811L 6X4-10H
Impeller	101	1	DI	24439-01-N6	0256-115-1013	811XLTX 8X6-15
Impeller	101	1	316SS	24439-01-91	0256-116-1203	811XLTX 8X6-15
Impeller	101	1	Alloy 20	24439-01-20	0256-116-1204	811XLTX 8X6-15
Impeller	101	1	CD4MCu	24439-01-X4	0256-116-1216	811XLTX 8X6-15
Impeller	101	1	DI	24441-01-N6	0256-121-1013	311XLTX 10X8-15C
Impeller	101	1	316SS	24441-01-91	0256-122-1203	311XLTX 10X8-15C
Impeller	101	1	Alloy 20	24441-01-20	0256-122-1204	311XLTX 10X8-15C
Impeller	101	1	CD4MCu	24441-01-X4	0256-122-1216	311XLTX 10X8-15C
Impeller	101	1	DI	21292-20-N6	076777-1013	811S 1X1.5-6
Impeller	101	1	DI	21293-20-N6	076778-1013	811S 3X1.5-6
Impeller	101	1	DI	21280-40-N6	076779-1013	811S 1.5X1-8
Impeller	101	1	DI	21281-40-N6	076780-1013	811S 3X1.5-8
Impeller	101	1	316SS	21292-20-91	076781-1203	811S 1X1.5-6
Impeller	101	1	Alloy 20	21292-20-20	076781-1204	811S 1X1.5-6
Impeller	101	1	CD4MCu	21292-20-X4	076781-1216	811S 1X1.5-6
Impeller	101	1	316SS	21293-20-91	076792-1203	811S 3X1.5-6
Impeller	101	1	Alloy 20	21293-20-20	076792-1204	811S 3X1.5-6
Impeller	101	1	CD4MCu	21293-20-X4	076792-1216	811S 3X1.5-6
Impeller	101	1	316SS	21280-40-91	076793-1203	811S 1.5X1-8
Impeller	101	1	Alloy 20	21280-40-20	076793-1204	811S 1.5X1-8
Impeller	101	1	CD4MCu	21280-40-X4	076793-1216	811S 1.5X1-8
Impeller	101	1	316SS	21281-40-91	076794-1203	811S 3X1.5-8
Impeller	101	1	Alloy 20	21281-40-20	076794-1204	811S 3X1.5-8
Impeller	101	1	CD4MCu	21281-40-X4	076794-1216	811S 3X1.5-8
Impeller	101	1	DI	21329-60-N6	076797-1013	811M 2X1-10
Impeller	101	1	DI	21335-01-N6	0B10172-1013	811S 3X2-6
Impeller	101	1	316SS	21335-01-91	0B10176-1203	811S 3X2-6
Impeller	101	1	Alloy 20	21335-01-20	0B10176-1204	811S 3X2-6
Impeller	101	1	CD4MCu	21335-01-X4	0B10176-1216	811S 3X2-6
Impeller	101	1	DI	21282-90-N6	0B10541-1013	811M 4X3-13
Impeller	101	1	316SS	21282-90-91	0B10542-1203	811M 4X3-13
Impeller	101	1	Alloy 20	21282-90-20	0B10542-1204	811M 4X3-13
Impeller	101	1	CD4MCu	21282-90-X4	0B10542-1216	811M 4X3-13
Impeller	101	1	316SS	L21423-90-91	0B10588-1203	811L 3X2-13
Impeller	101	1	Alloy 20	L21423-90-20	0B10588-1204	811L 3X2-13
Impeller	101	1	CD4MCu	L21423-90-X4	0B10588-1216	811L 3X2-13
Impeller	101	1	DI	L21423-90-N6	0B10589-1013	811L 3X2-13
Impeller	101	1	DI	N/A	0C00143A01-1013	811M 4X3-7
Impeller	101	1	316SS	N/A	0C00143A02-1203	811M 4X3-7
Impeller	101	1	Alloy 20	N/A	0C00143A02-1204	811M 4X3-7
Impeller	101	1	CD4MCu	N/A	0C00143A02-1216	811M 4X3-7
Impeller	101	1	DI	21275-60-N6	0C00262A01-1013	811M 4X3-10H

Goolds Parts in Ascending Order

Part	Item #	Qty Req.	Material	Griswold Part #	Goolds Part #	Model Used On
Impeller	101	1	316SS	21275-60-91	0C00262A02-1203	811M 4X3-10H
Impeller	101	1	Alloy 20	21275-60-20	0C00262A02-1204	811M 4X3-10H
Impeller	101	1	CD4MCu	21275-60-X4	0C00262A02-1216	811M 4X3-10H
Impeller	101	1	DI	21375-60-N6	0C02478A-1013	811M 6X4-10H
Impeller	101	1	316SS	21375-60-91	0C02521A-1203	811M 6X4-10H
Impeller	101	1	Alloy 20	21375-60-20	0C02521A-1204	811M 6X4-10H
Impeller	101	1	CD4MCu	21375-60-X4	0C02521A-1216	811M 6X4-10H
Thrust Bearing End Cover	109	1	Cast Iron	24016-01-01	102-828-1001-55356	811XLTX
Case	100	1	DI	21424-01-N6	104-421-1012	811S 1X1.5-6
Case	100	1	DI	21299-01-N6	104-422-1012	811S 3X1.5-6
Case	100	1	DI	21426-01-N6	104-423-1012	811S 1.5X1-8
Case	100	1	DI	21418-01-N6	104-424-1012	811S 3X1.5-8
Case	100	1	DI	21334-01-N6	104-445-1012	811M&L 2X1-10
Case	100	1	316SS	21424-01-91	104-554-1203	811S 1X1.5-6
Case	100	1	Alloy 20	21424-01-20	104-554-1204	811S 1X1.5-6
Case	100	1	CD4MCu	21424-01-X4	104-554-1216	811S 1X1.5-6
Case	100	1	316SS	21299-01-91	104-555-1203	811S 3X1.5-6
Case	100	1	Alloy 20	21299-01-20	104-555-1204	811S 3X1.5-6
Case	100	1	CD4MCu	21299-01-X4	104-555-1216	811S 3X1.5-6
Case	100	1	316SS	21426-01-91	104-556-1203	811S 1.5X1-8
Case	100	1	Alloy 20	21426-01-20	104-556-1204	811S 1.5X1-8
Case	100	1	CD4MCu	21426-01-X4	104-556-1216	811S 1.5X1-8
Case	100	1	316SS	21418-01-91	104-557-1203	811S 3X1.5-8
Case	100	1	Alloy 20	21418-01-20	104-557-1204	811S 3X1.5-8
Case	100	1	CD4MCu	21418-01-X4	104-557-1216	811S 3X1.5-8
Case	100	1	316SS	21334-01-91	104-878-1203	811M&L 2X1-10
Case	100	1	Alloy 20	21334-01-20	104-878-1204	811M&L 2X1-10
Case	100	1	CD4MCu	21334-01-X4	104-878-1216	811M&L 2X1-10
Case	100	1	DI	21331-01-N6	105-202-1012	811S 3X2-6
Case	100	1	316SS	21331-01-91	105-204-1203	811S 3X2-6
Case	100	1	Alloy 20	21331-01-20	105-204-1204	811S 3X2-6
Case	100	1	CD4MCu	21331-01-X4	105-204-1216	811S 3X2-6
Case	100	1	316SS	23018-01-91	247-35-1203	811M 3X2-6
Case	100	1	Alloy 20	23018-01-20	247-35-1204	811M 3X2-6
Case	100	1	CD4MCu	23018-01-X4	247-35-1216	811M 3X2-6
Case	100	1	DI	23018-01-N6	247-36-1012	811M 3X2-6
Case	100	1	316SS	21336-01-91	247-41-1203	811M 3X2-8
Case	100	1	Alloy 20	21336-01-20	247-41-1204	811M 3X2-8
Case	100	1	CD4MCu	21336-01-X4	247-41-1216	811M 3X2-8
Case	100	1	DI	21336-01-N6	247-42-1012	811M 3X2-8
Case	100	1	316SS	21005-01-91	247-43-1203	811M 4X3-8
Case	100	1	Alloy 20	21005-01-20	247-43-1204	811M 4X3-8
Case	100	1	CD4MCu	21005-01-X4	247-43-1216	811M 4X3-8
Case	100	1	DI	21005-01-N6	247-44-1012	811M 4X3-8
Case	100	1	316SS	21004-01-91	247-45-1203	811M 4X3-8G
Case	100	1	Alloy 20	21004-01-20	247-45-1204	811M 4X3-8G
Case	100	1	CD4MCu	21004-01-X4	247-45-1216	811M 4X3-8G
Case	100	1	DI	21004-01-N6	247-46-1012	811M 4X3-8G
Case	100	1	DI	21271-01-N6	249-54-1012	811M&L3X1.5-10
Case	100	1	DI	21327-01-N6	249-55-1012	811M&L 3X2-10
Case	100	1	DI	21274-01-N6	249-56-1012	811M&L 4X3-10
Case	100	1	DI	21295-01-N6	249-57-1012	811M&L 3X1.5-13
Case	100	1	DI	21289-01-N6	249-59-1012	811M&L 4X3-13
Case	100	1	316SS	21271-01-91	249-60-1203	811L 3X1.5-10
Case	100	1	316SS	21271-01-91	249-60-1203	811M&L 3X1.5-10
Case	100	1	Alloy 20	21271-01-20	249-60-1204	811L 3X1.5-10
Case	100	1	CD4MCu	21271-01-X4	249-60-1216	811L 3X1.5-10
Case	100	1	CD4MCu	21271-01-X4	249-60-1216	811M 3X1.5-10
Case	100	1	316SS	21327-01-91	249-61-1203	811M&L 3X2-10
Case	100	1	Alloy 20	21327-01-20	249-61-1204	811M&L 3X2-10
Case	100	1	CD4MCu	21327-01-X4	249-61-1216	811M&L 3X2-10

Goolds Parts in Ascending Order

Part	Qty	Material	Griswold Part #	Goolds Part #	Model Used On	
Part	Item #	Req.	Material	Part #	Part #	Model Used On
Case	100	1	316SS	21274-01-91	249-62-1203	811M&L 4X3-10
Case	100	1	Alloy 20	21274-01-20	249-62-1204	811M&L 4X3-10
Case	100	1	CD4MCu	21274-01-X4	249-62-1216	811M&L 4X3-10
Case	100	1	316SS	21295-01-91	249-63-1203	811M&L 3X1.5-13
Case	100	1	Alloy 20	21295-01-20	249-63-1204	811M&L 3X1.5-13
Case	100	1	CD4MCu	21295-01-X4	249-63-1216	811M&L 3X1.5-13
Case	100	1	316SS	21289-01-91	249-65-1203	811M&L 4X3-13
Case	100	1	Alloy 20	21289-01-20	249-65-1204	811M&L 4X3-13
Case	100	1	CD4MCu	21289-01-X4	249-65-1216	811M&L 4X3-13
Case	100	1	316SS	21007-01-91	251-89-1203	811M&L 6X4-10
Case	100	1	Alloy 20	21007-01-20	251-89-1204	811M&L 6X4-10
Case	100	1	CD4MCu	21007-01-X4	251-89-1216	811M&L 6X4-10
Case	100	1	DI	21007-01-N6	251-91-1012	811M&L 6X4-10
Case	100	1	DI	24435-01-N6	254-93-1012	811XLTX 8X6-15
Case	100	1	316SS	24435-01-91	254-94-1203	811XLTX 8X6-15
Case	100	1	Alloy 20	24435-01-20	254-94-1204	811XLTX 8X6-15
Case	100	1	CD4MCu	24435-01-X4	254-94-1216	811XLTX 8X6-15
Case	100	1	DI	24436-01-N6	256-64-1012	311XLTX 10X8-15C
Case	100	1	316SS	24436-01-91	256-65-1203	311XLTX 10X8-15C
Case	100	1	Alloy 20	24436-01-20	256-65-1204	311XLTX 10X8-15C
Case	100	1	CD4MCu	24436-01-X4	256-65-1216	311XLTX 10X8-15C
Adapter	108	1	DI	24286-01-N6	262-92-1013	811M 7" & 8"
Adapter	108	1	DI	24285-01-N6	262-93-1013	811L 10"
Adapter	108	1	DI	24291-01-N6	262-94-1013	811L 13"
Gland Stud	353	2	316 SS	21855-02-06	27177-439-2229	811XLTX
Gland Stud	353	4	316 SS	21855-01-04	27177-588-2229	811S 6" & 8"
Gland Stud	353	2	316 SS	21855-02-04	27177-607-2229	811M&L
Stud - Stuffing Box	370H	2	316 SS	21855-02-04	27177-626-2228	811XLTX
Stud - Stuffing Box	370H	2	304 SS	3862-83	27177-664-2228	811S 6" & 8"
Stud - Stuffing Box	370H	2	304 SS	3862-84	27177-715-2228	811M&L
Hex Nut - Stuffing Box Stud	357K	2	304 SS	3932-82	495073-2228	811M&L
Gland Stud Nut	355	4	304 SS	3932-8	495074-2228	811S 6" & 8"
Bearing Housing Hex Jam Nut	423	3	Steel	3932-8	49507542210	811S
Bearing Housing Hex Jam Nut	423	3	Steel	3932-62	49507-57-2210	811M&L
Hex Nut - Stuffing Box Stud	357K	2	304 SS	3932-62	49507-57--2228	811XLTX
Bearing Housing Hex Jam Nut	423	3	Steel	3932-62	49507-59-2210	811XLTX
Gland Stud Nut	355	2	304 SS	3932-72	495077-2228	811M,L,&XLTX
Capscrew, Brg End Cover to Brg Housing	371C	6	Steel	3861-12	49511-102-2210	811XLTX
Capscrews Frame - Foot	370F	2	Steel	14178701	49511-203-2210	811M,L&XLTX
Capscrew Frame - Adapter	370B	4	Steel	3861-22	49511-204-2210	811M,L&XLTX.
Capscrew Frame - Case	370	12	Steel	3861-36	49511252-2210	811M
Capscrew Frame - Case	370	8	Steel	3861-36	49511252-2210	811M 4X3-7
Capscrew Frame - Case	370	16	Steel	3861-36	49511-252-2210	811L
Capscrew Frame - Case	370	16	Steel	3861-36	49511-252-2210	811M
Capscrew Frame - Case	370	12	Steel	3861-36	49511-252-2210	811M&L
Capscrew Frame - Case	370	8	STEEL	3861-36	49511-252-2210	811M
Capscrew Frame - Case	370	4	Steel	3861-167	49511-252-2210	811S
Capscrew Adp. - Case	370	24	Steel	3861-72	49511-253-2210	811XLTX
Capscrew Adp. - Case	370	24	304 SS	3861-74	49511-253-2228	811XLTX
Bolts Bearing Housing - Frame	370C	4	Steel	3861-72	49511-254-2210	811XLTX
Capscrews, Clamp Ring	236A	10	Steel	24384-03-01	49511-50-2210	811L
Hex Bolts - Jacking	418	2	304 SS	14129613	49521-104-2228	811S
Bolts/Bearing Housing Imp. Adjusting	370D	3	Steel	3831-92	49521-204-2210	811M&L
Hex Bolts - Jacking	418	3	Steel	3861-22	49521-204-2228	811M,L&XLTX
Bolts Bearing Housing Imp. Adjusting	370D	4	Steel	3861-82	49521-305-2210	811XLTX
Bolts Bearing Housing - Frame	370C	3	Steel	14129613	495211042210	811S
Coupling Key	400	1	Steel	4372-02-21	49568-118-2213	811M
Coupling Key	400	1	Steel	4372-08-21	49568-302-2213	811L
Coupling Key	400	1	Steel	4372-25-21	49568-409-2213	811XLTX
Coupling Key	400	1	Steel	4372-23-21	49568612213	811S
Oil Mist Connection Plug	408H	4	Steel	8505-02-02	57042-103	811S,M,L&XLTX

Goolds Parts in Ascending Order

Part	Item #	Qty Req.	Material	Griswold Part #	Goolds Part #	Model Used On
Bearing Housing Retaining Ring	361A	1	Steel	18464-1	58101281	811S
Bearing Housing Retaining Ring	361A	1	Steel	18464-14	5810139313	811M
Constant Oiler Plug	408J	1	Steel	8505-02-03	63122-2-2210	811M,L&XLTX
Oil Fill Plug	113	1	Steel	8505-03-01	6312242210	811S
Oil Fill Plug	113	1	Steel	3/1/05	63122-4-2210	811M,L&XLTX
Case Gasket	351	1	Teflon	10399-54-05	70782-19-5117	811M 3X2-6
Case Gasket	351	1	Gylon	10399-54-06	70782-19-5118	811M 3X2-6
Case Gasket	351	1	EPDM	10399-54-03	70782-19-5127	811M 3X2-6
Case Gasket	351	1	Teflon	10399-51-05	70782-20-5117	811M
Case Gasket	351	1	Gylon	10399-51-06	70782-20-5118	811M
Case Gasket	351	1	EPDM	10399-51-03	70782-20-5127	811M
Gland Gasket-STD Box	360Q	1	EDPM	18408-6	70782-24-5127	811L
Case Gasket	351	1	Teflon	10399-49-05	70782-28-5117	811M&L
Case Gasket	351	1	Gylon	10399-49-06	70782-28-5118	811M&L
Case Gasket	351	1	EPDM	10399-49-03	70782-28-5127	811M&L
Case Gasket	351	1	Teflon	10399-49-05	70782-29-5117	811M&L
Case Gasket	351	1	Gylon	10399-49-06	70782-29-5118	811M&L
Case Gasket	351	1	EPDM	10399-49-03	70782-29-5127	811M
Gland Gasket-STD Box	360Q	1	EDPM	18408-5	70782-30-5127	811M
Case Gasket	351	1	Teflon	10399-68-05	70782-49-5117	811XLTX
Case Gasket	351	1	Gylon	10399-68-06	70782-49-5118	811XLTX
Case Gasket	351	1	EPDM	10399-68-03	70782-49-5127	811XLTX
Case Gasket	351	1	Teflon	10399-53-05	70782-81-5117	811S 6"
Case Gasket	351	1	Gylon	10399-53-06	70782-81-5118	811S 6"
Case Gasket	351	1	EPDM	10399-53-03	70782-81-5127	811S 6"
Case Gasket	351	1	Teflon	10399-52-05	70782-82-5117	811S 8"
Case Gasket	351	1	Gylon	10399-52-06	70782-82-5118	811S 8"
Case Gasket	351	1	EPDM	10399-52-03	70782-82-5127	811S 8"
Dowel Pin, Frame to Adapter	469B	2	Steel	18407-7	71091-3	811XLTX
Finned Tube Cooler Inlet Plug 1/2" NPT	408L	1	Steel	8505-04-01	7301-0008	811M,L&XLTX
Finned Tube Cooler Inlet Plug 1/2" NPT	408L	1	Steel	23445-2	7301-0008	811S
Finned Tube Cooler Outlet Plug 1" NPT	408M	1	Steel	31006307	7301-0016	811S,M,L&XLTX
Gasket, Frame To Adapter	360D	1	VELLUMOID	24400	73078-5130-0001	811 M,L, & XLTX
Deflector MT Only	123	1	Fld-Tef	18422-07-94	73519-2	811M
Deflector LTC Only	123	1	Fld-Tef	18422-08-94	73519-3	811L
Deflector XLT Only	123	1	Fld-Tef	18422-09-94	73519-8	811XLTX
Dowel Pin Frame - Adapter	469B	2	Steel	8372	73523-3	811M&L
Sleeve	126	1	316SS	21276-01-91	73705X-2229	811M
Sleeve	126	1	Alloy 20	21276-01-20	73705X2230	811M
Gasket, Brg End Cover to Brg Housing	360	1	VELLUMOID	18408-7	75704-5130-0007	811XLTX
Sleeve	126	1	316SS	24007-01-31	76230X-2229	811XLTX
Sleeve	126	1	Alloy 20	24007-01-20	76230X-2230	811XLTX
Sleeve	126	1	316 SS	21339-01-91	76772X-2229	811S
Sleeve	126	1	Alloy 20	21399-01-20	76772X-2230	811S
Deflector ST Only	123	1	Fld-Tef	18422-06-94	76776-1	811S
8" Adapter Ring	503	1	Duct Iron	24215-01-01	76782-1013	811S
Outboard Bearing	112	1	Steel	18463-10	8049-30600	811S
Outboard Bearing	112	1	Steel	18463-12	8049-30900	811M
Outboard Bearing	112	1	Steel	18463-18	8049-31300	811XLTX
Inboard Bearing	168	1	Steel	18463-11	8050-20760	811S
Inboard Bearing	168	1	Steel	18463-13	8050-30960	811M
Inboard Bearing	168	1	Steel	18463-15	8050-31160	811L
Inboard Bearing	168	1	Steel	18463-17	8050-31360	811XLTX
Thrust Bearing Locknut	136	1	Steel	6123-1	8601-0006	811S
Thrust Bearing Locknut	136	1	Steel	6123-6	8601-0009	811M
Thrust Bearing Locknut	136	1	Steel	6123-5	8601-0010	811L
Thrust Bearing Locknut	136	1	Steel	6125-8	8601-0013	811XLTX
OutBoard Bearing Lip Seal	332	1	Buna	18465-9	860-13535	811S
OutBoard Bearing Lip Seal	332	1	Buna	18465-11	8690-11220	811M
Inboard Bearing Lip Seal	333	1	Buna	18465-12	8690-17645	811M
OutBoard Bearing Lip Seal	332	1	Buna	18465-15	8690-18727	811XLTX

Goulds Parts in Ascending Order

Part	Item #	Qty Req.	Material	Griswold Part #	Goulds Part #	Model Used On
OutBoard Bearing Lip Seal	332	1	Buna	18465-13	8690-18727	811L
Inboard Bearing Lip Seal	333	1	Buna	18465-16	8690-21228	811XLTX
Inboard Bearing Lip Seal	333	1	Buna	18465-14	8690-21228	811L
Inboard Bearing Lip Seal	333	1	Buna	18465-10	8690-63447	811S
Thrust Bearing Lockwasher	382	1	Steel	6124-1	8910-0006	811S
Thrust Bearing Lockwasher	382	1	Steel	6124-6	8910-0009	811M
Thrust Bearing Lockwasher	382	1	Steel	6124-5	8910-0010	811L
Thrust Bearing Lockwasher	382	1	Steel	6124-8	8910-0013	811XLTX
Sleeve	126	1	316SS	21551-01-91	91967X-2229	811L
Sleeve	126	1	Alloy 20	21551-01-20	91967X-2230	811L
Oil Drain Plug	408A	1	Steel	6652-1	A00152A01	811XLTX
Oil Drain Plug	408A	1	Steel	6652-1	A00152A01	811L
Oil Drain Plug	408A	1	Steel	6652-1	A00152A01	811M
Oil Drain Plug	408A	1	Steel	6652-1	A00152A01	811S
Outboard Lab'y Seal INPRO	332	1	Bronze	18470-7	A00710A01	811L
Inboard Lab'y Seal INPRO	333	1	Bronze	18470-8	A00711A01	811L
Inboard Lab'y Seal INPRO	333	1	Bronze	18470-5	A00745A01	811M
Outboard Lab'y Seal INPRO	332	1	Bronze	18470-4	A00746A01	811M
Inboard Lab'y Seal INPRO	333	1	Bronze	18470-11	A00785A01	811XLTX
Outboard Lab'y Seal INPRO	332	1	Bronze	18470-10	A00786A01	811XLTX
Outboard Lab'y Seal INPRO	332	1	Bronze	18470-1	A00915A01	811S
Inboard Lab'y Seal INPRO	333	1	Bronze	18470-2	A00930A01	811S
Packing	106	1	Kevlar	21647-16-4	A01081A06	811M
Packing	106	1	Kevlar	21647-21-4	A01081A07	811L
Packing	106	1	Kevlar	21647-22-4	A01081A12	811XLTX
Packing	106	1	Tef/Imp	21647-13-7	A01081A14	811S
Sight Glass	319	1	Stl/Glass	34307	A01154A05	811S,M,L&XLTX
Impeller Pipe Plug & Washer	358Y	1	DI/316SS	21001-01-91	A02827A04-2229	811XLTX
Impeller Pipe Plug & Washer	358Y	1	CD4/Alloy 20	21001-01-20	A02827A04-2230	811XLTX
Oil Thrower	248	1	Steel	24384-04-41	A03712A-3201	811L
Impeller Washer	428D	1	Teflon	21002-01-WS	A05105A01	811XLTX
Frame Foot 13"	241	1	Cast Iron	24420-01-01	B02091A-1001-63986	811M&L
Frame Foot 8" & 10"	241	1	Cast Iron	24421-01-01	B02092A-1001-63987	811M&L
Clamp Ring	253B	1	Steel	24384-02-41	B02168A-2210	811L
O-Ring Outboard Lab'y Seal - Rotating	497F	1	Viton	216V	C024951A2165304	811M
O-Ring Outboard Lab'y Seal - Rotating	497F	1	Viton	225V	C024951A225-5304	811L
O-Ring Outboard Lab'y Seal - Rotating	497F	1	Viton	229V	C024951A229-5304	811XLTX
O-Ring Inboard Lab'y Seal - Rotating	497H	1	Viton	138V	C02495A138-5304	811L
O-Ring Inboard Lab'y Seal - Rotating	497H	1	Viton	144V	C02495A144-5304	811XLTX
O-Ring Inboard Lab'y Seal - Stationary	497J	1	Viton	146V	C02495A146-5304	811S
O-Ring Inboard Lab'y Seal - Stationary	497J	1	Viton	147V	C02495A147-5304	811L
O-Ring Inboard Lab'y Seal - Stationary	497J	1	Viton	151V	C02495A151-5304	811XLTX
O-Ring Outboard Lab'y Seal - Rotating	497F	1	Viton	20V	C02495A20-5304	811S
O-Ring Inboard Lab'y Seal - Rotating	497H	1	Viton	220V	C02495A220-5304	811S
O-Ring Outboard Lab'y Seal - Stationary	497G	1	Viton	224V	C02495A2245304	811M
O-Ring Inboard Lab'y Seal - Rotating	497H	1	Viton	224V	C02495A2245304	811M
O-Ring Outboard Lab'y Seal - Stationary	497G	1	Viton	230V	C02495A230-5304	811L
O-Ring Inboard Lab'y Seal - Stationary	497J	1	Viton	231V	C02495A2315304	811M
O-Ring Outboard Lab'y Seal - Stationary	497G	1	Viton	234V	C02495A234-5304	811XLTX
Impeller O-Ring	412A	1	Teflon	18461-14-38	C02495A236359	811S
Bearing Housing O-Ring	496	1	Buna	18461-04-71	C02495A236-5302	811S
O-Ring Outboard Lab'y Seal - Stationary	497G	1	Viton	24V	C02495A24-5304	811S
Bearing Housing O-Ring	496	1	Buna	251B	C02495A251-5302	811L
Bearing Housing O-Ring	496	1	Buna	252B	C02495A261-5302	811XLTX
Impeller O-Ring	412A	1	Teflon	18461-15-38	C02495A286359	811M&L
Impeller O-Ring	412A	1	Teflon	21003-01-OR	C02495A34-6359	811XLTX
Bearing Housing	134	1	Cast Iron	24082-01-01	C03340A100056097	811S
Frame Foot	241	1	Cast Iron	24018-01-01	C04366A-69160	811XLTX
Impeller	101	1	DI	L21374-60-N6	C06088A-1013	811L 6X4-10G
Impeller	101	1	316SS	L21374-60-91	C06089A-1203	811L 6X4-10G
Impeller	101	1	Alloy 20	L21374-60-20	C06089A-1204	811L 6X4-10G

Goulds Parts in Ascending Order

Part	Qty	Material	Griswold Part #	Goulds Part #	Model Used On	
Item #	Req.					
Impeller	101	1	CD4MCu	L21374-60-X4	C06089A-1216	811L 6X4-10G
Impeller	101	1	DI	21374-60-N6	C06348A-1013	811M 6X4-10G
Impeller	101	1	316SS	21374-60-91	C06349A-1203	811M 6X4-10G
Impeller	101	1	Alloy 20	21374-60-20	C06349A-1204	811M 6X4-10G
Impeller	101	1	CD4MCu	21374-60-X4	C06349A-1216	811M 6X4-10G
Bearing Housing O-Ring	496	1	Buna	18461-01-71	CO2495A245-5304	811M
Case	100	1	DI	N/A	D00247A01-1012	811M 4X3-7
Case	100	1	316SS	N/A	D00247A02-1203	811M 4X3-7
Case	100	1	Alloy 20	N/A	D00247A02-1204	811M 4X3-7
Case	100	1	CD4MCu	N/A	D00247A02-1216	811M 4X3-7
Case	100	1	DI	21006-01-N6	D00452A01-1012	811M&L 4X3-10H
Case	100	1	316SS	21006-01-91	D00452A02-1203	811M&L 4X3-10H
Case	100	1	Alloy 20	21006-01-20	D00452A02-1204	811M&L 4X3-10H
Case	100	1	CD4MCu	21006-01-X4	D00452A02-1216	811M&L 4X3-10H
Case	100	1	316SS	21296-01-91	D02450A-1203	811M&L 3X2-13
Case	100	1	Alloy 20	21296-01-20	D02450A-1204	811M&L 3X2-13
Case	100	1	CD4MCu	21296-01-X4	D02450A-1216	811M&L 3X2-13
Case	100	1	DI	21296-01-N6	D02451A-1012	811M&L 3X2-13
Case	100	1	316SS	21009-01-91	D03123A-1203	811M&L 6X4-10H
Case	100	1	Alloy 20	21009-01-20	D03123A-1204	811M&L 6X4-10H
Case	100	1	CD4MCu	21009-01-X4	D03123A-1216	811M&L 6X4-10H
Case	100	1	DI	21009-01-N6	D03194A-1012	811M&L 6X4-10H
Bearing Housing	134	1	Cast Iron	24384-01-01	D04628A-1000-68227	811L
Bearing Housing	134	1	Cast Iron	24015-01-01	D04871A-1001-55357	811XLTX
Bearing Housing	134	1	Cast Iron	24383-01-01	D04872A100056376	811M
Case	100	1	DI	21431-01-N6	D04928A-1012	811M&L 6X4-13
Case	100	1	316SS	21431-01-91	D04930A-1203	811M&L 6X4-13
Case	100	1	Alloy 20	21431-01-20	D04930A-1204	811M&L 6X4-13
Case	100	1	CD4MCu	21431-01-X4	D04930A-1216	811M&L 6X4-13
Outboard Lab'y Seal	332	1	Teflon	18470-1P	D08717A016241	811S
Inboard Lab'y Seal	333	1	Teflon	18470-2P	D08717A026241	811S
Outboard Lab'y Seal	332	1	Teflon	18470-4P	D08717A03-6241	811M
Inboard Lab'y Seal	333	1	Teflon	18470-5P	D08717A04-6241	811M
Outboard Lab'y Seal	332	1	Teflon	18470-7P	D08717A05-6241	811L
Inboard Lab'y Seal	333	1	Teflon	18470-8P	D08717A06-6241	811L
Outboard Lab'y Seal	332	1	Teflon	18470-10P	D08717A07-6241	811XLTX
Inboard Lab'y Seal	333	1	Teflon	18470-11P	D08717A08-6241	811XLTX
Case	100	1	DI	21008-01-N6	D08740A-1012	811M&L 6X4-10G
Case	100	1	316SS	21008-01-91	D08742A-1203	811M&L 6X4-10G
Case	100	1	Alloy 20	21008-01-20	D08742A-1204	811M&L 6X4-10G
Case	100	1	CD4MCu	21008-01-X4	D08742A-1216	811M&L 6X4-10G
Case	100	1	316SS	21329-60-91	OB10009-1203	811M 2X1-10
Case	100	1	Alloy 20	21329-60-20	OB10009-1204	811M 2X1-10
Case	100	1	CD4MCu	21329-60-X4	OB10009-1216	811M 2X1-10
Impeller	101	1	DI	L21282-90-N6	OB10591-1013	811L 4X3-13
Impeller	101	1	316SS	L21282-90-91	OB10592-1203	811L 4X3-13
Impeller	101	1	Alloy 20	L21282-90-20	OB10592-1204	811L 4X3-13
Impeller	101	1	CD4MCu	L21282-90-X4	OB10592-1216	811L 4X3-13
Power Frame For Sleeveless Design	920A	1	A20 Shaft	PF811LG20NSLV	P1600LOS00-X000	811L
Power Frame For Sleeve Design	920B	1	4140 Shaft	PF811LG41SLV	P1600LOS00-X050	811L
Power Frame For Sleeve Design	920B	1	316 SS Shaft	PF811LG91SLV	P1600LOS00-X060	811L
Power Frame For Sleeveless Design	920A	1	316 SS Shaft	PF811LG91NSLV	P1600LOS00-X080	811L
Power Frame For Sleeveless Design	920A	1	A20 Shaft	PF811MD20NSLV	P1600MOS00-X000	811M
Power Frame For Sleeve Design	920B	1	4140 Shaft	PF811MD41SLV	P1600MOS00-X050	811M
Power Frame For Sleeve Design	920B	1	316 SS Shaft	PF811MD91SLV	P1600MOS00-X060	811M
Power Frame For Sleeveless Design	920A	1	316 SS Shaft	PF811MD91NSLV	P1600MOS00-X080	811M
Power Frame For Sleeveless Design	920A	1	A20 Shaft	PF811SM20NSLV	P1600SOS00-X000	811S
Power Frame For Sleeve Design	920B	1	4140 Shaft	PF811SM41SLV	P1600SOS00-X050	811S
Power Frame For Sleeve Design	920B	1	316 SS Shaft	PF811SM91SLV	P1600SOS00-X060	811S
Power Frame For Sleeveless Design	920A	1	316 SS Shaft	PF811SM91NSLV	P1600SOS00-X080	811S
Power Frame For Sleeveless Design	920A	1	A20 Shaft	PF811XLGNSLV	P1600XOS00-X000	811XLTX

Goulds Parts in Ascending Order

Part	Item #	Qty Req.	Material	Griswold Part #	Goulds Part #	Model Used On
Power Frame For Sleeve Design	920B	1	4140 Shaft	PF811XLG41SLV	P1600X0S00-X050	811XLTX
Power Frame For Sleeve Design	920B		316 SS Shaft	PF811XLG91SLV	P1600X0S00-X060	811XLTX
Power Frame For Sleeveless Design	920A	1	316 SS Shaft	PF811XLG91NSLV	P1600X0S00-X080	811XLTX
Stuffing Box - Standard Bore	184	1	DI	23024-01-N6	R100-107-1012	811M 3X2-6
Stuffing Box - Standard Bore	184	1	DI	21550-01-N6	R100-111-1012	811M 8"
Stuffing Box - Standard Bore	184	1	316SS	21290-01-91	R100-529-1203	811M 13"
Stuffing Box - Standard Bore	184	1	Alloy 20	21290-01-20	R100-529-1204	811M 13"
Stuffing Box - Standard Bore	184	1	CD4MCu	21290-01-X4	R100-529-1216	811M 13"
Stuffing Box - Standard Bore	184	1	DI	21290-01-N6	R100-530-1012	811M 13"
Stuffing Box - Standard Bore	184	1	316SS	L21290-01-91	R100-533-1203	811L 13"
Stuffing Box - Standard Bore	184	1	Alloy 20	L21290-01-20	R100-533-1204	811L 13"
Stuffing Box - Standard Bore	184	1	CD4MCu	L21290-01-X4	R100-533-1216	811L 13"
Stuffing Box - Standard Bore	184	1	DI	L21290-01-N6	R100-534-1012	811L 13"
Stuffing Box - Standard Bore	184	1	316SS	21279-01-91	R100-585-1203	811M 10"
Stuffing Box - Standard Bore	184	1	Alloy 20	21279-01-20	R100-585-1204	811M 10"
Stuffing Box - Standard Bore	184	1	CD4MCu	21279-01-X4	R100-585-1216	811M 10"
Stuffing Box - Standard Bore	184	1	DI	21279-01-N6	R100-586-1012	811M 10"
Stuffing Box - Standard Bore	184	1	316SS	L21279-01-91	R100-589-1203	811L 10"
Stuffing Box - Standard Bore	184	1	Alloy 20	L21279-01-20	R100-589-1204	811L 10"
Stuffing Box - Standard Bore	184	1	CD4MCu	L21279-01-X4	R100-589-1216	811L 10"
Stuffing Box - Standard Bore	184	1	DI	L21279-01-N6	R100-590-1012	811L 10"
Stuffing Box - Standard Bore	184	1	316SS	23024-01-91	R100-786-1203	811M 3X2-6
Stuffing Box - Standard Bore	184	1	CD4MCu	23024-01-X4	R100-786-1216	811M 3X2-6
Stuffing Box - Standard Bore	184	1	Alloy 20	23024-01-20	R100-786-1240	811M 3X2-6
Stuffing Box - Standard Bore	184	1	316SS	21550-01-91	R100-788-1203	811M 8"
Stuffing Box - Standard Bore	184	1	Alloy 20	21550-01-20	R100-788-1204	811M 7"&8"
Stuffing Box - Standard Bore	184	1	CD4MCu	21550-01-X4	R100-788-1216	811M 7"&8"
Adapter	108	1	DI	24446-01-N6	R102-814-1013	811XLTX
Shaft for sleeve design	122		316 SS	24003-01-31A	R103-614-2229	811XLTX
Shaft for sleeve design	122	1	4140	24003-01-41A	R103-614-2238	811XLTX
Shaft for sleeveless design	122		A20	24003-02-20A	R103-615-2230	811XLTX
Stuffing Box - Standard Bore	184	1	DI	21284-01-N6	R104-429-1012	811S 6"&8"
Shaft for sleeveless design	122	1	316 SS	24000-02-31A	R104-434-2229	811S
Shaft for sleeveless design	122	1	A20	24000-02-20A	R104-434-2230	811S
Shaft for sleeve design	122	1	316 SS	24000-01-31A	R104-435-2229	811S
Shaft for sleeve design	122	1	4140	24000-01-41A	R104-435-2238	811S
Stuffing Box - Standard Bore	184	1	316SS	21284-01-91	R104-562-1203	811S 3X2-6
Stuffing Box - Standard Bore	184	1	316SS	21284-01-91	R104-562-1203	811S 3X1.5-6
Stuffing Box - Standard Bore	184	1	316SS	21284-01-91	R104-562-1203	811S 1X1.5-6
Stuffing Box - Standard Bore	184	1	Alloy 20	21284-01-20	R104-562-1204	811S 6"
Stuffing Box - Standard Bore	184	1	CD4MCu	21284-01-X4	R104-562-1216	811S 6"
Stuffing Box - Standard Bore	184	1	316SS	21417-01-91	R104-564-1203	811S 8"
Stuffing Box - Standard Bore	184	1	Alloy 20	21417-01-20	R104-564-1204	811S 8"
Stuffing Box - Standard Bore	184	1	CD4MCu	21417-01-X4	R104-564-1216	811S 8"
Stuffing Box - Standard Bore	184	1	DI	24443-01-N6	R104-709-1012	811XLTX
Stuffing Box - Standard Bore	184	1	316SS	24443-01-91	R104-710-1203	811XLTX
Stuffing Box - Standard Bore	184	1	Alloy 20	24443-01-20	R104-710-1204	811XLTX
Stuffing Box - Standard Bore	184	1	CD4MCu	24443-01-X4	R104-710-1216	811XLTX
Shaft for sleeveless design	122	1	316 SS	24001-02-31A	R104-731-2229	811M
Shaft for sleeveless design	122	1	A20	24001-02-20A	R104-731-2230	811M
Shaft for sleeve design	122	1	316 SS	24001-01-31A	R104-733-2229	811M
Shaft for sleeve design	122	1	4140	24001-01-41A	R104-733-2238	811M
Repair Kit	906A	1	Various	RK-3196L	R196LXPRKO	811L
Maintenance Kit	902	1	Various	K-3196L-10	R196-MKL10	811L 10"
Maintenance Kit	902	1	Various	K-3196L-13	R196-MKL13	811L 13"
Maintenance Kit	902	1	Various	K-3196M-10	R196-MKM10	811M 10"
Maintenance Kit	902	1	Various	K-3196M-13	R196-MKM13	811M 13"
Maintenance Kit	902	1	Various	K-3196-M-6	R196-MKM6	811M 6"
Maintenance Kit	902	1	Various	K-3196M-8	R196-MKM8	811M 7"&8"
Maintenance Kit	902	1	Various	K-3196S-6	R196-MKS6	811S 6"
Maintenance Kit	902	1	Various	K-3196S-8	R196-MKS8	811S 8"

Goulds Parts in Ascending Order

Part	Item #	Qty Req.	Material	Griswold Part #	Goulds Part #	Model Used On
Maintenance Kit	902	1	Various	K-3196XL-15	R196-MKX15	811XLTX
Repair Kit	906A	1	Various	RK-3196M	R196MTPRKO	811M
Repair Kit	906A	1	Various	RK-3196S	R196STPRKO	811S
Repair Kit	906A	1	Various	RK-3196X	R196XLPRKO	811XLTX
Lantern Ring	105	1	Teflon	21275	R76293	811M
Lantern Ring	105	1	Teflon	21555	R76295	811L
Lantern Ring	105	1	Teflon	21600	R76298	811XLTX
Lantern Ring	105	1	Teflon	21414	R76775	811S
Outboard Bearing	112	2	Steel	18463-16	R8057-3-1029	811L
Plain Gland	107	1	316SS	21415-01-91	RB01049A1203	811S
Plain Gland	107	1	316 SS	21277-0-91	RB01050A-1203	811M
Plain Gland	107	1	316 SS	21553-01-91	RC01298A-1203	811L
Stuffing Box - Taper Bore	184	1	316SS	24284-02-91	RC01382A01-1203	811S 6"
Stuffing Box - Taper Bore	184	1	Alloy 20	24284-02-20	RC01382A01-1204	811S 6"
Stuffing Box - Taper Bore	184	1	CD4MCu	24284-02-X4	RC01382A01-1216	811S 6"
Stuffing Box - Taper Bore	184	1	DI	24284-02-N6	RC01382A03-1012	811S 6"
Stuffing Box - Taper Bore	184	1	316SS	24417-02-91	RC01382A07-1203	811S 8"
Stuffing Box - Taper Bore	184	1	Alloy 20	24417-02-20	RC01382A07-1204	811S 8"
Stuffing Box - Taper Bore	184	1	CD4MCu	24417-02-X4	RC01382A07-1216	811S 8"
Stuffing Box - Taper Bore	184	1	DI	24417-02-N6	RC01382A09-1012	811S 8"
Stuffing Box - Taper Bore	184	1	Alloy 20	L24279-02-20	RC01382A31-1204	811L 10"
Stuffing Box - Taper Bore	184	1	316SS	L24290-02-91	RC01382A37-1203	811L 13"
Stuffing Box - Taper Bore	184	1	Alloy 20	L24290-02-20	RC01382A37-1204	811L 13"
Stuffing Box - Taper Bore	184	1	CD4MCu	L24290-02-X4	RC01382A37-1216	811L 13"
Stuffing Box - Taper Bore	184	1	DI	L24290-02-N6	RC01382A39-1012	811L 13"
Stuffing Box - Taper Bore	184	1	316SS	24443-02-91	RC01382A49-1203	811XLTX
Stuffing Box - Taper Bore	184	1	Alloy 20	24443-02-20	RC01382A49-1204	811XLTX
Stuffing Box - Taper Bore	184	1	CD4MCu	24443-02-X4	RC01382A49-1216	811XLTX
Stuffing Box - Taper Bore	184	1	DI	24443-02-N6	RC01382A51-1012	811XLTX
Shaft for sleeve design	122	1	316 SS	24002-01-31A	RC03044A-2229	811L
Shaft for sleeve design	122	1	4140	24002-01-41A	RC03044A-2238	811L
Shaft for sleeveless design	122	1	316 SS	24002-02-31A	RC03132A-2229	811L
Shaft for sleeveless design	122	1	A20	24002-02-20A	RC03132A-2230	811L
Plain Gland	107	1	316 SS	24017-01-91	RC03355A-1203	811XLTX
Stuffing Box - Taper Bore	184	1	DI	24550-02-N6	RC04047A-1012	811M 7",8"&10"
Stuffing Box - Taper Bore	184	1	316SS	24550-02-91	RC04109A01-1203	811M 7",8"
Stuffing Box - Taper Bore	184	1	Alloy 20	24550-02-20	RC04109A01-1204	811M 7"&8"
Stuffing Box - Taper Bore	184	1	CD4MCu	24550-02-X4	RC04109A01-1216	811M 7",8",10"
Stuffing Box - Taper Bore	184	1	316SS	24279-02-91	RC04110A01-1203	811M 10"
Stuffing Box - Taper Bore	184	1	Alloy 20	24279-02-20	RC04110A01-1204	811M 10"
Stuffing Box - Taper Bore	184	1	CD4MCu	24279-02-X4	RC04110A01-1216	811M 10"
Stuffing Box - Taper Bore	184	1	316SS	24290-02-91	RC04111A01-1203	811M 13"
Stuffing Box - Taper Bore	184	1	Alloy 20	24290-02-20	RC04111A01-1204	811M 13"
Stuffing Box - Taper Bore	184	1	CD4MCu	24290-02-X4	RC04111A01-1216	811M 13"
Stuffing Box - Taper Bore	184	1	316SS	L24279-02-91	RCO1382A31-1203	811L 10"
Stuffing Box - Taper Bore	184	1	CD4MCu	L24279-02-X4	RCO1382A31-1216	811L 10"
Stuffing Box - Taper Bore	184	1	DI	L24279-02-N6	RCO1382A33-1012	811L 10"
Frame	228	1	Duct Iron	24340-01-01	RD04539AA101363977	811S
Frame	228	1	Cast Iron	24288-01-01	RD04540AA100163983	811M
Frame	228	1	Cast Iron	24288-02-01	RD04548AA-1001-63984	811L
Frame	228	1	Cast Iron	24011-01-01	RE00666AA-1001-68146	811XLTX

Griswold Pump Company

Griswold Pump Company manufactures a complete line of ANSI pumps for the chemical process market. We have since the 1970's. Our parts are used everyday to build complete pumps that perform in critical applications around the world. Our quality assurance programs insure that all parts are manufactured to the highest standards and within their engineered tolerances. Tolerances that assure each and every part in the entire pump maintain a precise fit to insure pump performance and long life.

Our pumps, and therefore parts, are engineered and manufactured for specific functions. Our application engineers can assist you in selecting the right pump in the right material for your application. Let us help solve your pump problems.

Our ready to ship inventory of parts and pumps in ductile iron, stainless steel, alloy 20 and CD4MCu assures a quick delivery. Same day on parts and 36 hours on complete pumps!